

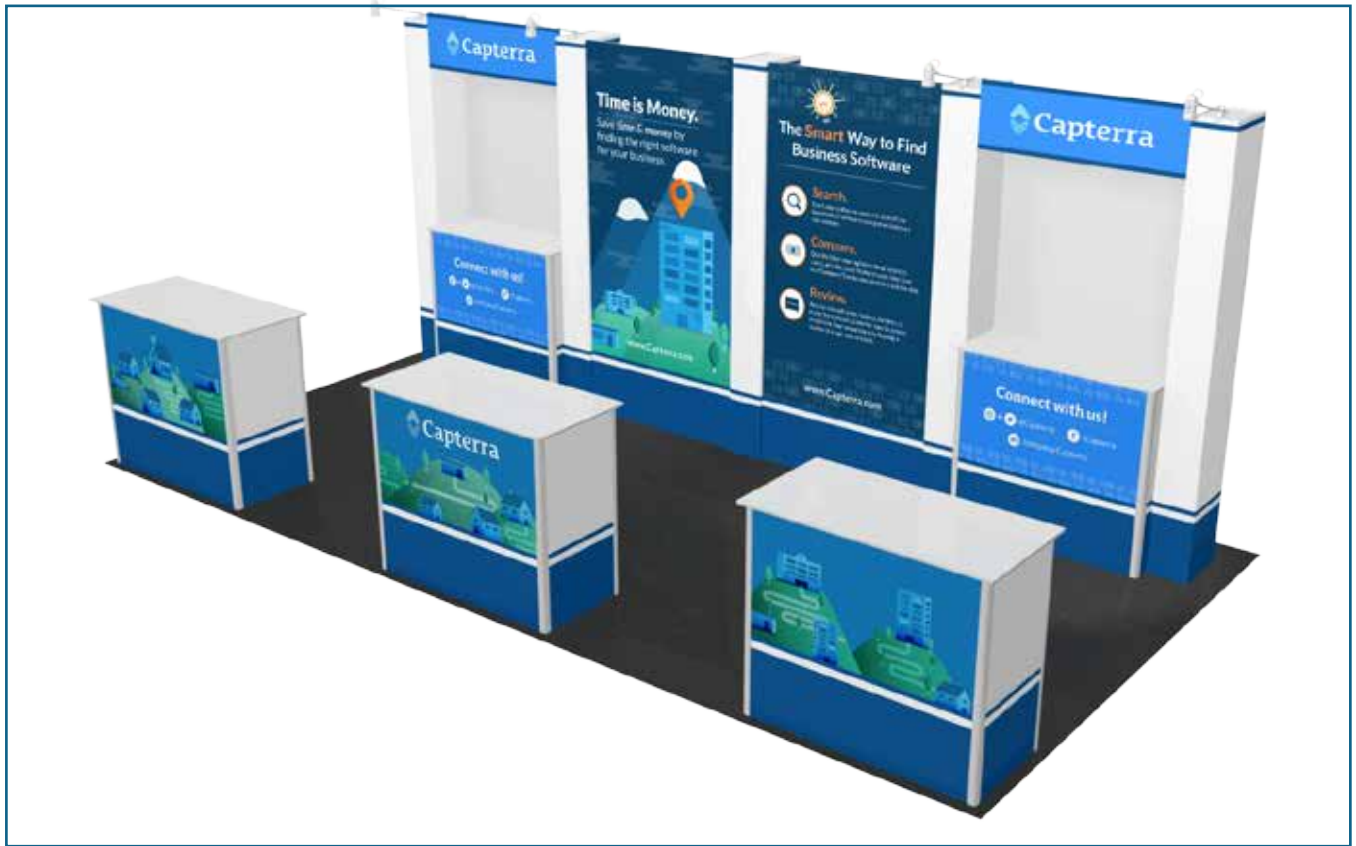

Display Setup Instructions



10' x 20' Display Booth



Steps to Assemble the InfiniLite Multi Section Exhibit Booth:

- Step 1:** Assemble Pillars.
- Step 2:** Place Pillars upright in their proper order.
- Step 3:** Attach Wall Panels to Pillars.
- Step 4:** Attach Front Partial Panels to Pillars.
- Step 5:** Assemble Frame For Backlit Graphics.
- Step 6:** Attach Flourescent Lights to Wall panels.
- Step 5:** Attach Fabric Prints to Frames
- Step 6:** Attach Signs to inside of Pillars with Velcro.
- Step 7:** Assemble Counters and place them in front of Wall Panels.
- Step 8:** Attach Posters To Pedistals
- Step 8:** Attach Stem Lights to Pillars.

Assembly Instructions: 20' Multi 4 Section Counter & Graphic Display

Assemble the Pillars.

A) Unfold the Pillar Panels with the front sides facing downward.

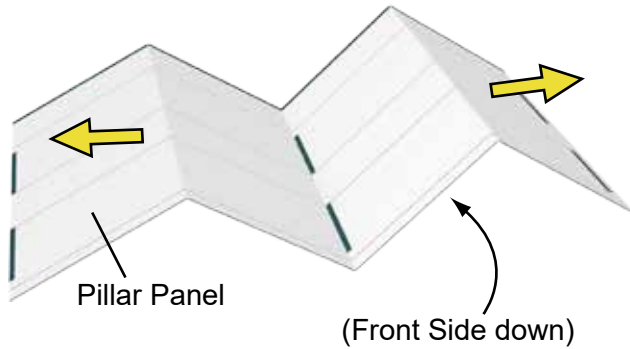

B) Attach the Top, Middle and Bottom Supports to the back of the Pillars with Velcro.

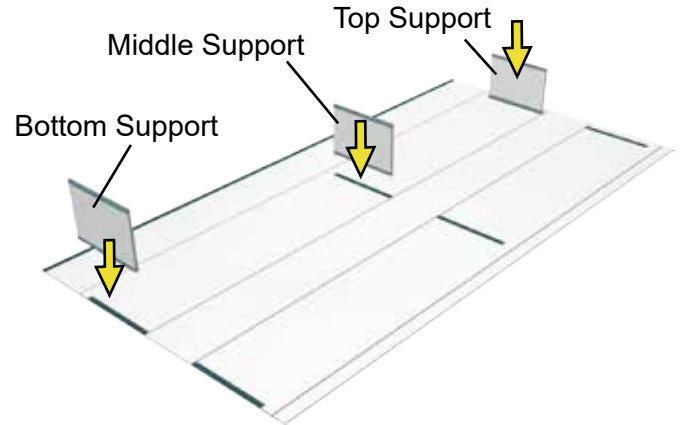

C) Fold Pillar around the Supports and attach with Velcro.

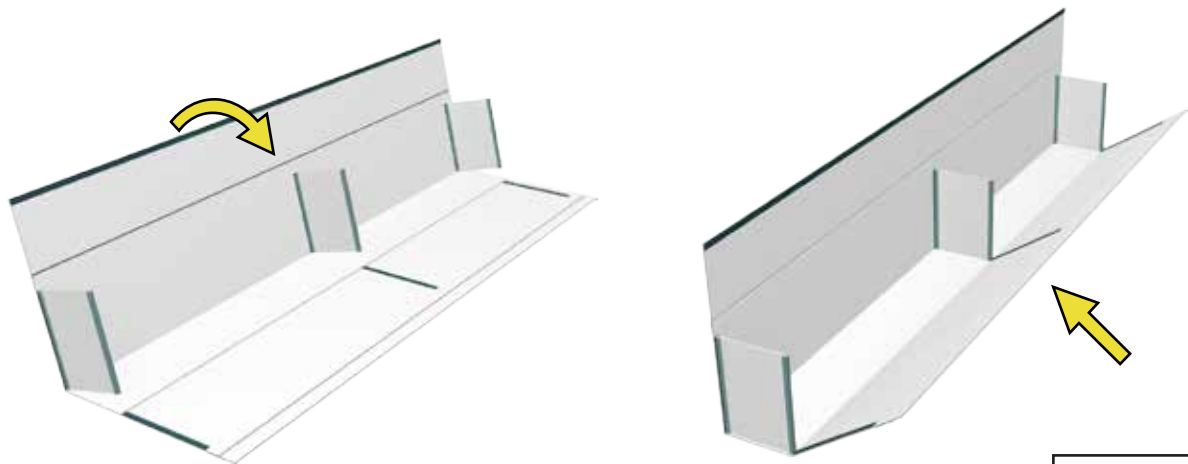

D) Close the Pillar using the Velcro strips along the Pillar edges.

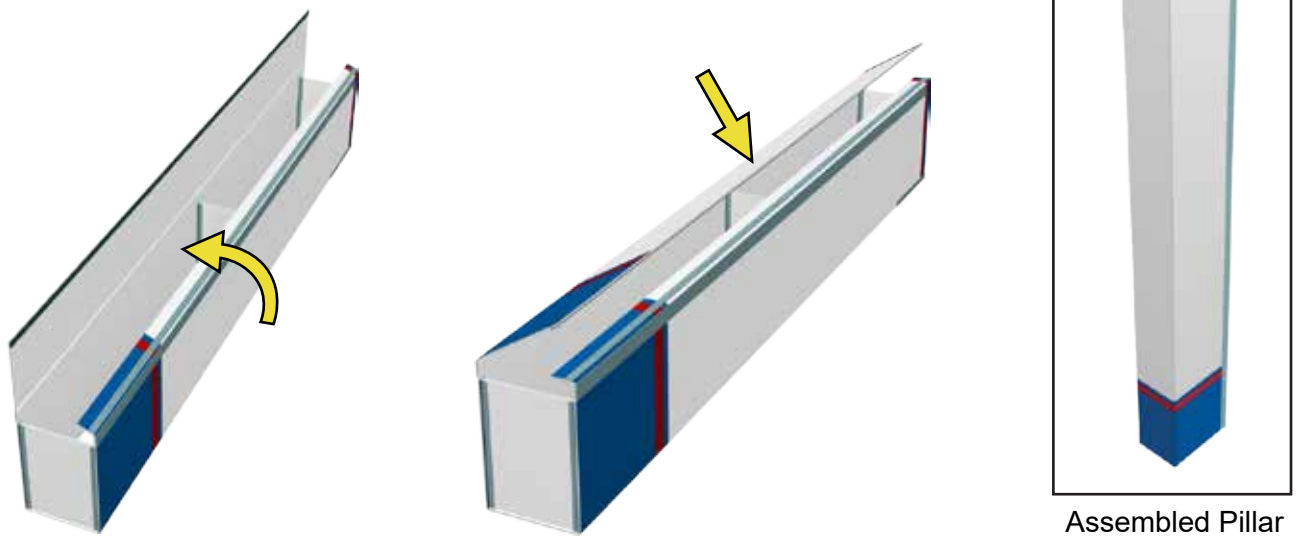

Assembled Pillar

Assembly Instructions:

20' Multi 4 Section Counter & Graphic Display

The following Floor Plan identifies the locations of the Booth Components:

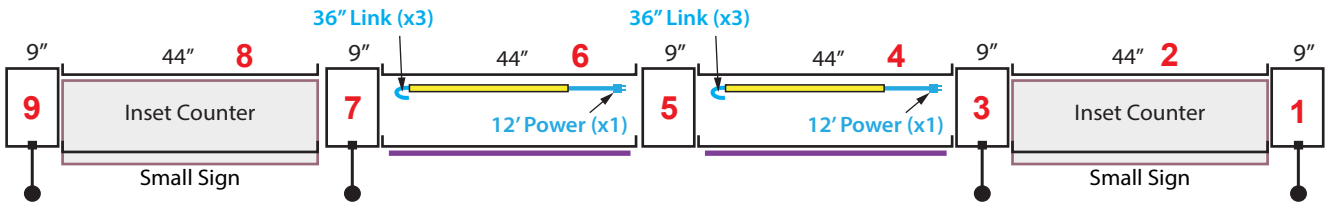

TOP VIEW

Floor Plan: 10'x20'

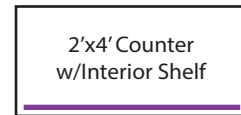
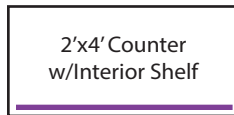
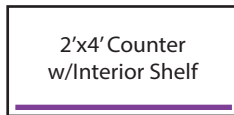

Place the assembled Pillars upright in their proper order and assigned locations as numbered and indicated on the Floor Plan.

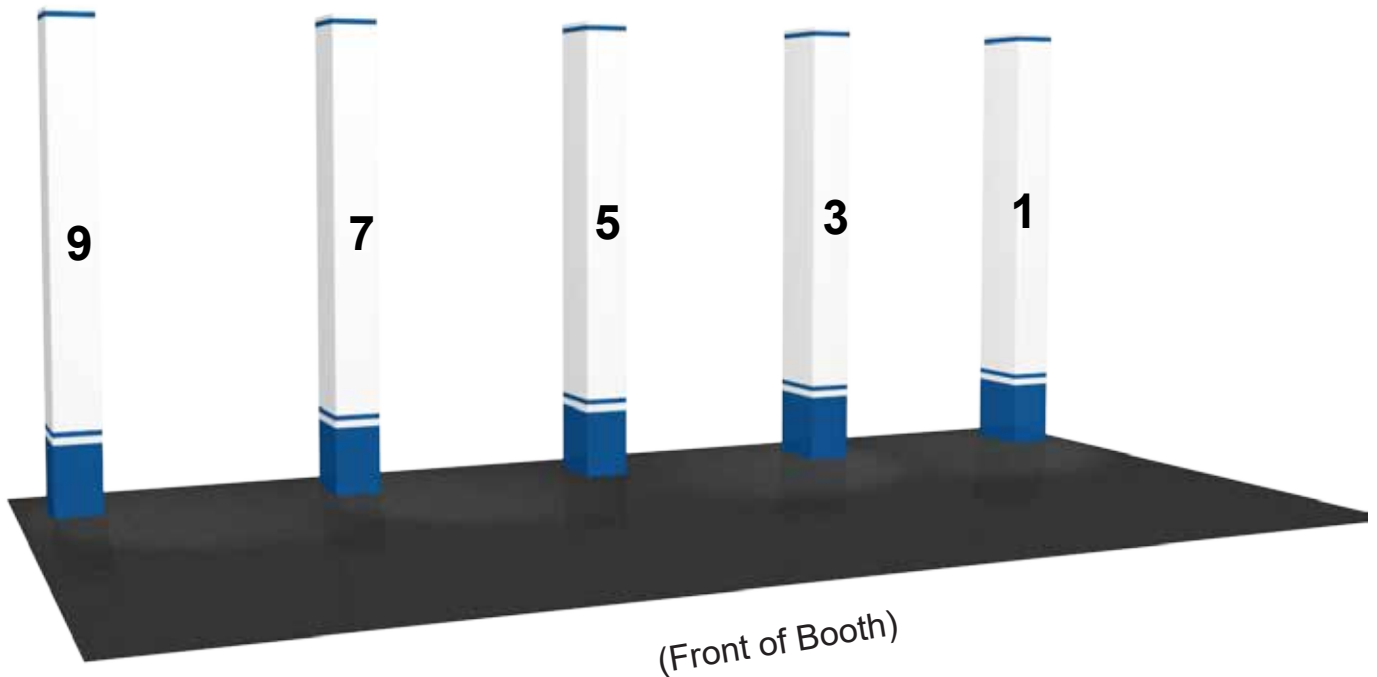

Attach Wall Panels to Pillars.

A) Unfold the bottom half of the Wall Panel, hold upright and attach to the side of the Pillar with Velcro. (Make sure that the Pillar and Wall Panel are **flat** on the floor surface when attaching and that the accent stripes are aligned with each other.) Begin assembly from either the left or right side of the Booth.

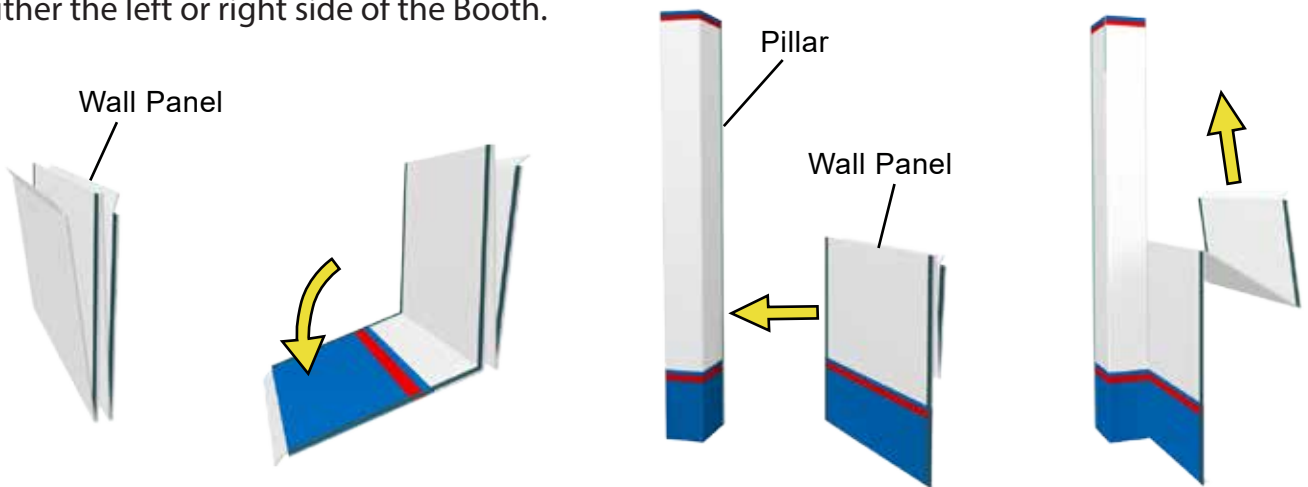

B) Unfold the top half of the Wall Panel and attach it to the top half of the Pillar matching the Velcro strips along the edges. Rotate the Wall Panel into position. Attach the next Pillar to the Wall Panel so that it is flat against the front face of the Wall Panel. Rotate the Pillar into position.

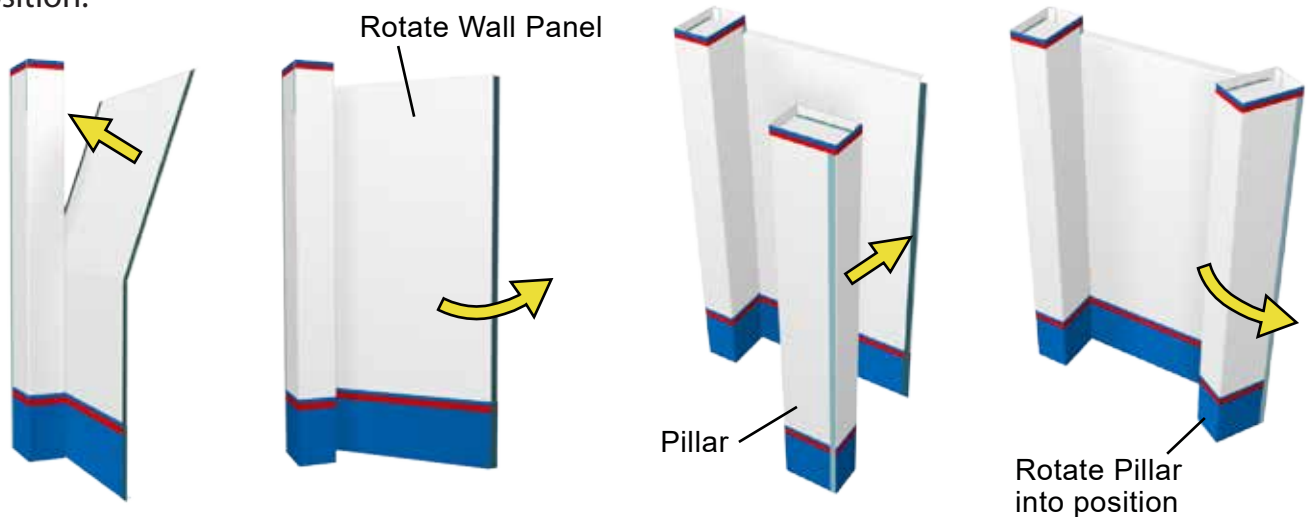

C) Repeat this process with the remaining Wall Panels and Pillars.



Assembly Instructions:

20' Multi 4 Section Counter & Graphic Display

Attach the Lightbox Panel to the Pillars.

A) Attach one end of the Lightbox Panel to the middle Panel.

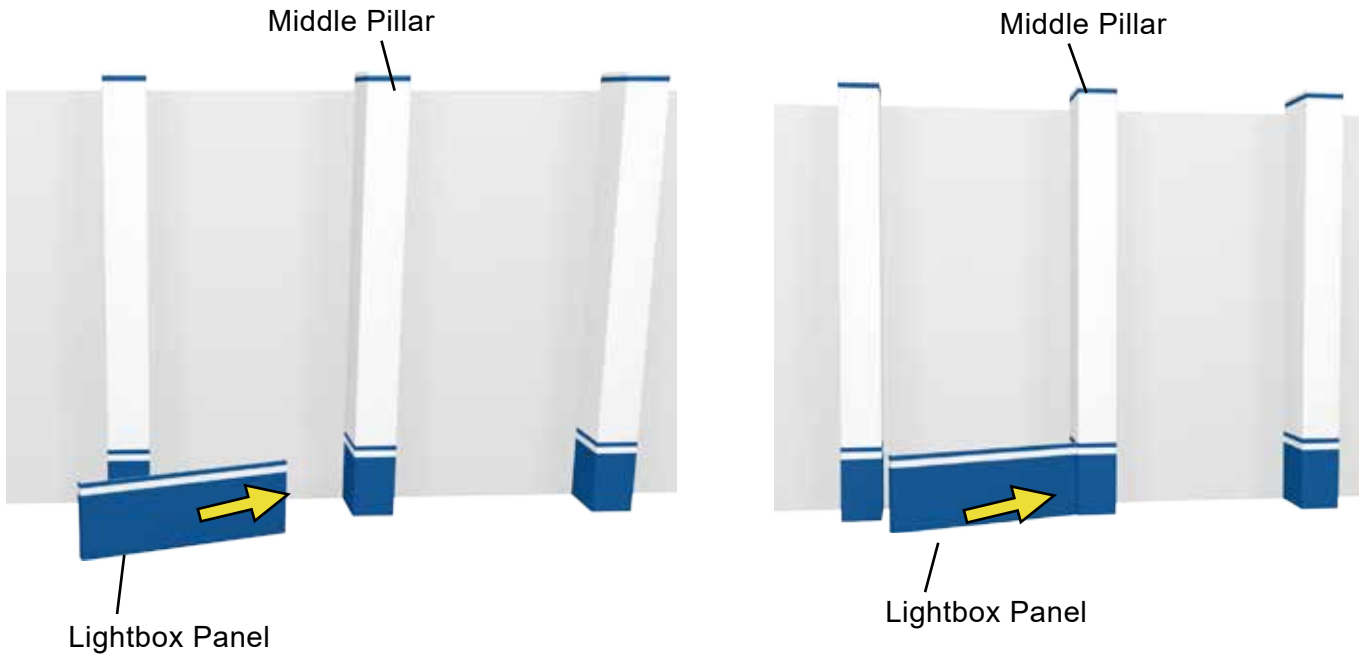

B) Rotate the End Pillar into position and attach it to the Lightbox Panel with Velcro.

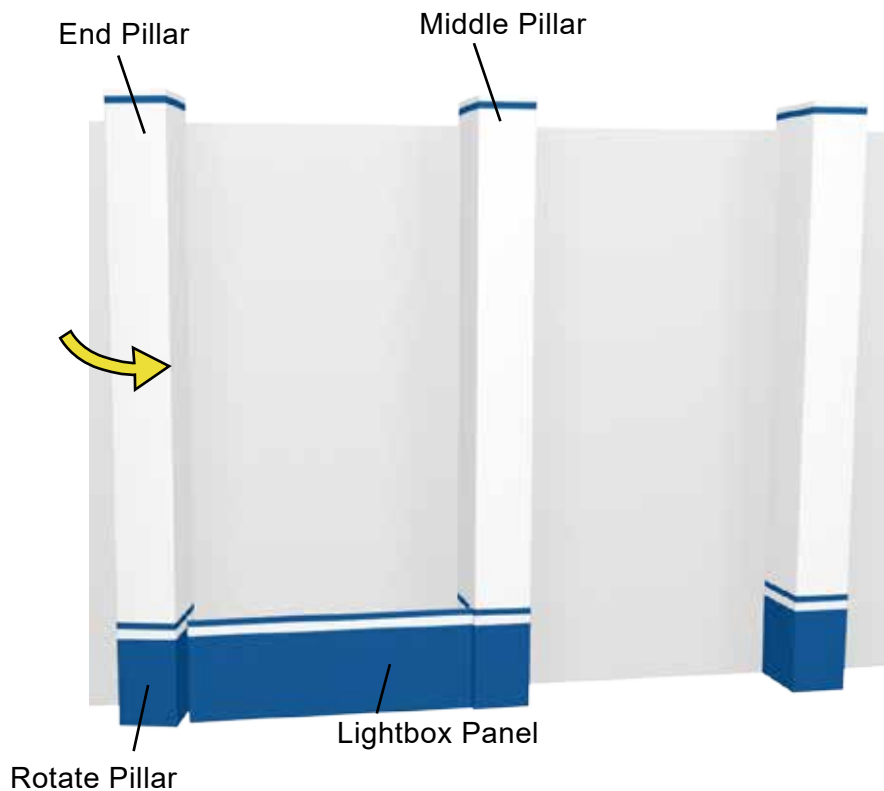

Assembly Instructions:

20' Multi 4 Section Counter & Graphic Display

Attach the (4) Fluorescent Lights to the back wall panel with Velcro and connect them in series.

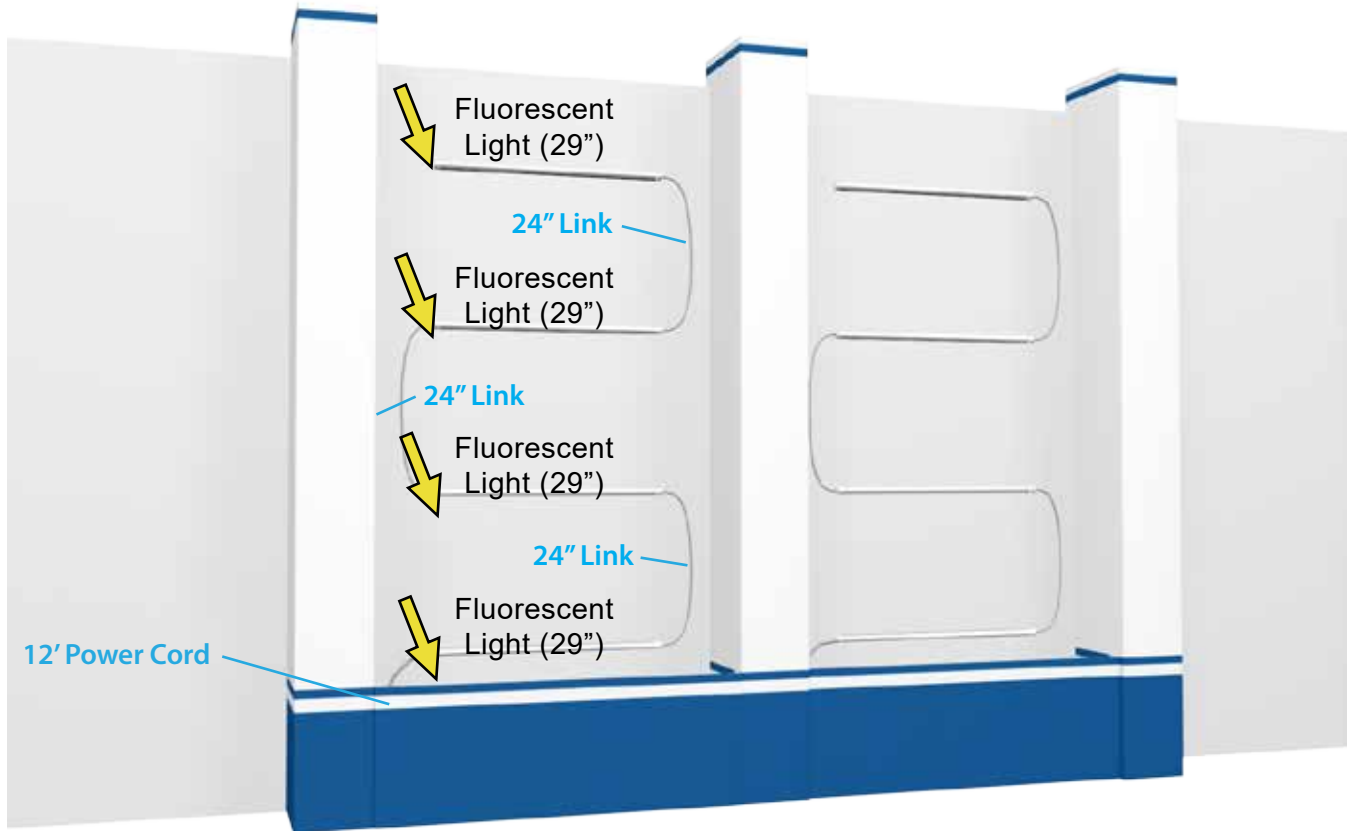

Run the power cord between the wall panel and Pillar and connect it to a Power Strip located along the back of the booth.

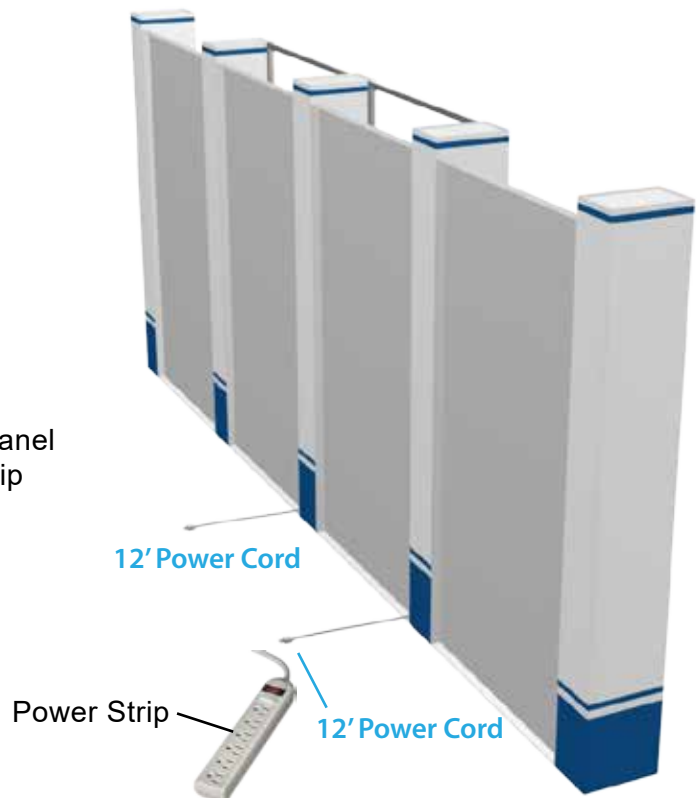

Assemble the Poster Frame and attach it to the assembly.

A) The components of the Poster Frame are shown below.

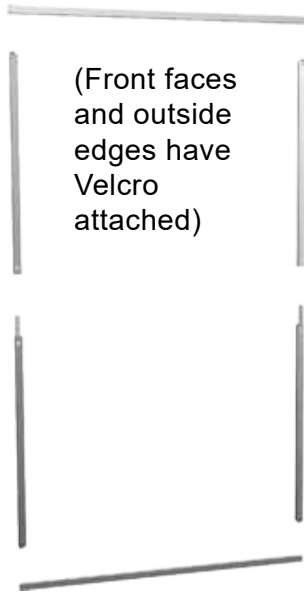

B) Assemble the vertical pairs together with the vertical connectors and machine screws.

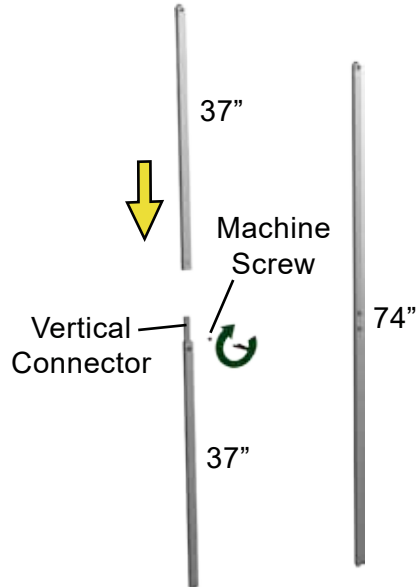

C) Attach the Vertical components to the top and bottom components with the tension locks.

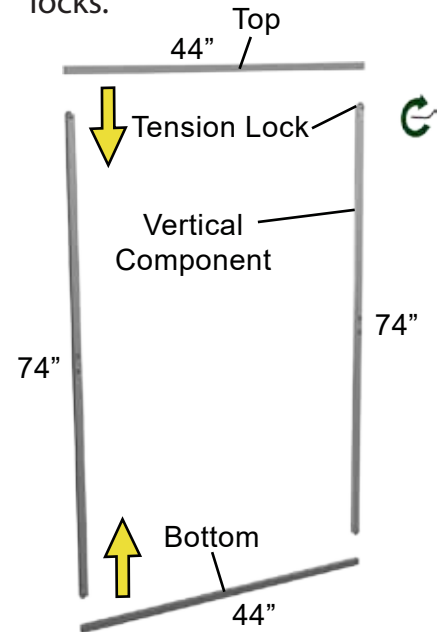

D) Turn the frame around so that the Velcro side faces to the front.



E) Connect the Poster Frame to the assembly with Velcro. - should connect to both left and right pillars and lower light box panel

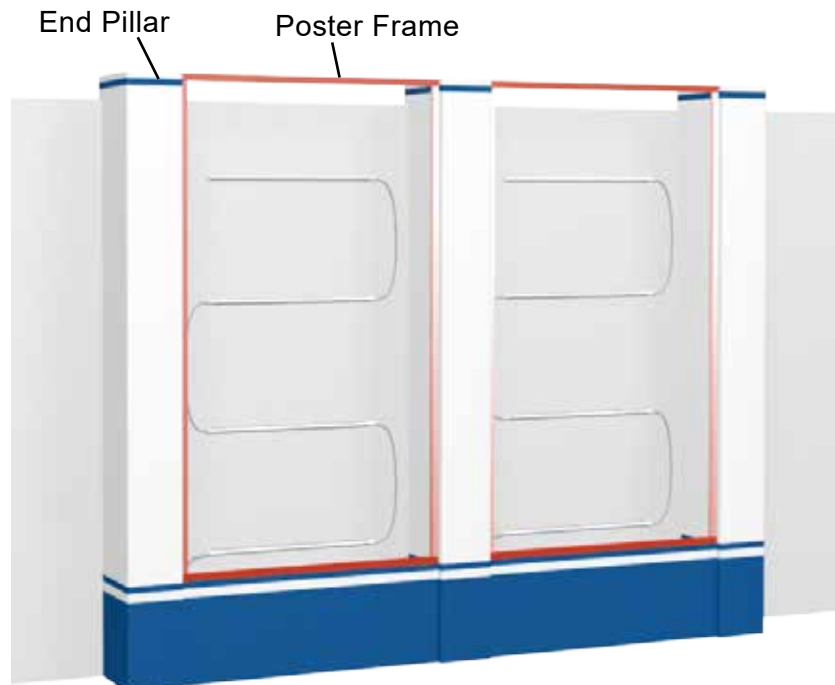

Assembly Instructions: 20' Multi 4 Section Counter & Graphic Display

Attach the Fabric Graphic to the Poster Frame with Velcro.

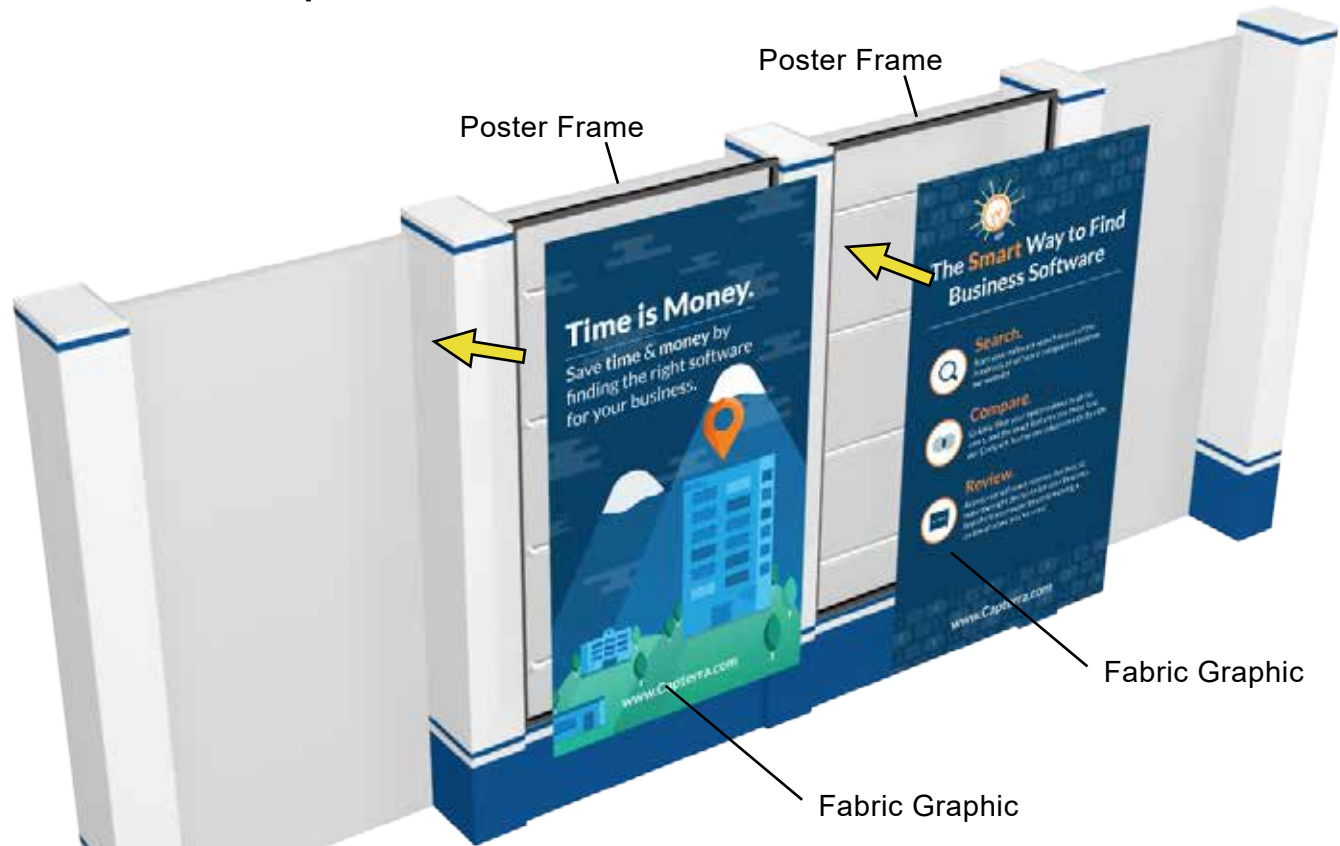

Assembly Instructions:

20' Multi 4 Section Counter & Graphic Display

Attach the Small Sign to the inside of the Pillars with Velcro.



Assembly Instructions: 20' Multi 4 Section Counter & Graphic Display

Assemble Counters and place them in front of the back Wall Panels.

A) Connect Panels A, B, C & D together with the 90° Channels.

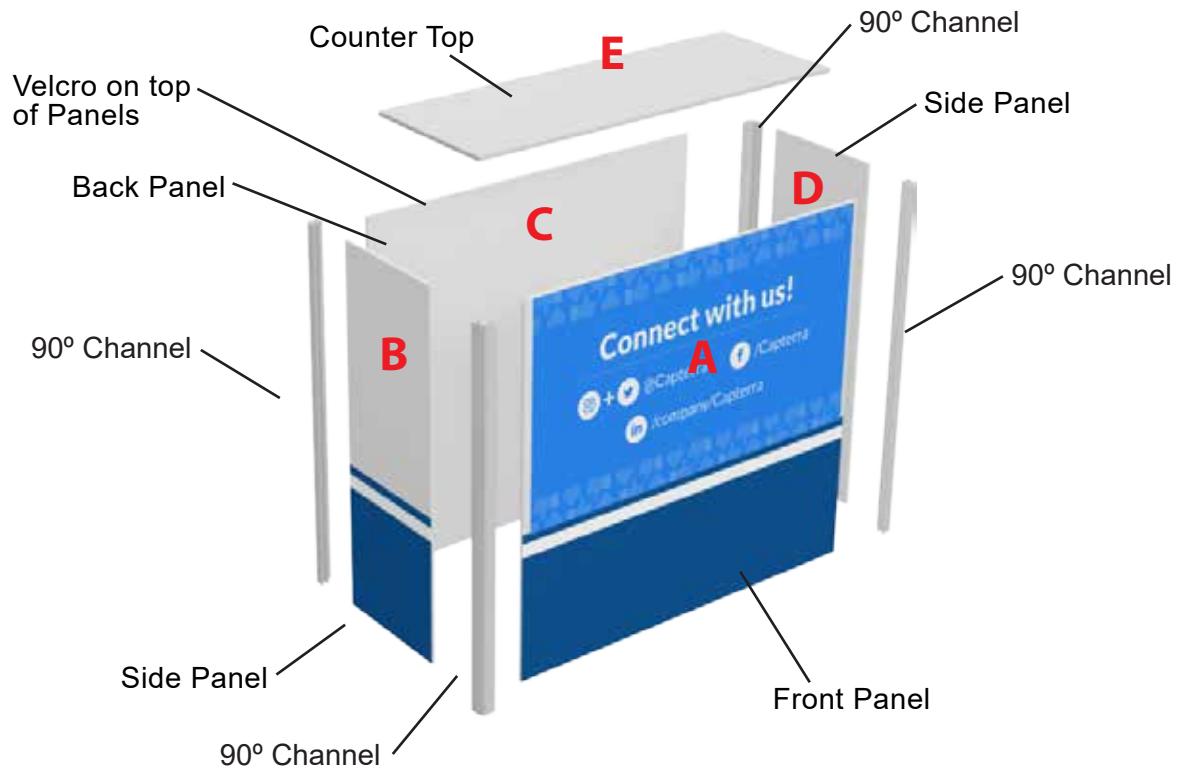

B) Attach the Counter Top to the tops of the Panels with Velcro.

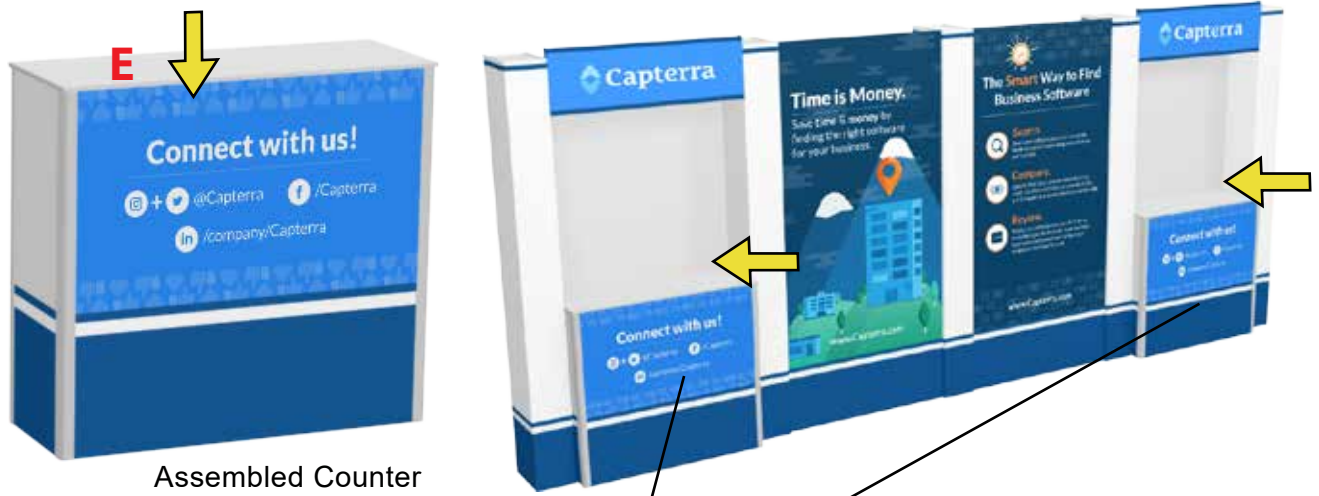

Note: **THERE ARE TWO SIZES OF PEDISTALS**
 BACKWALL PEDISTALS SHOULD BE 44.5 x 16.5

Place the Counters in front of the Wall Panels.

Counter Assembly:

A) Connect the Counter Panels together with the 90° Channels and Velcro. (Make sure that the Velcro is on top to attach the Counter Top.)

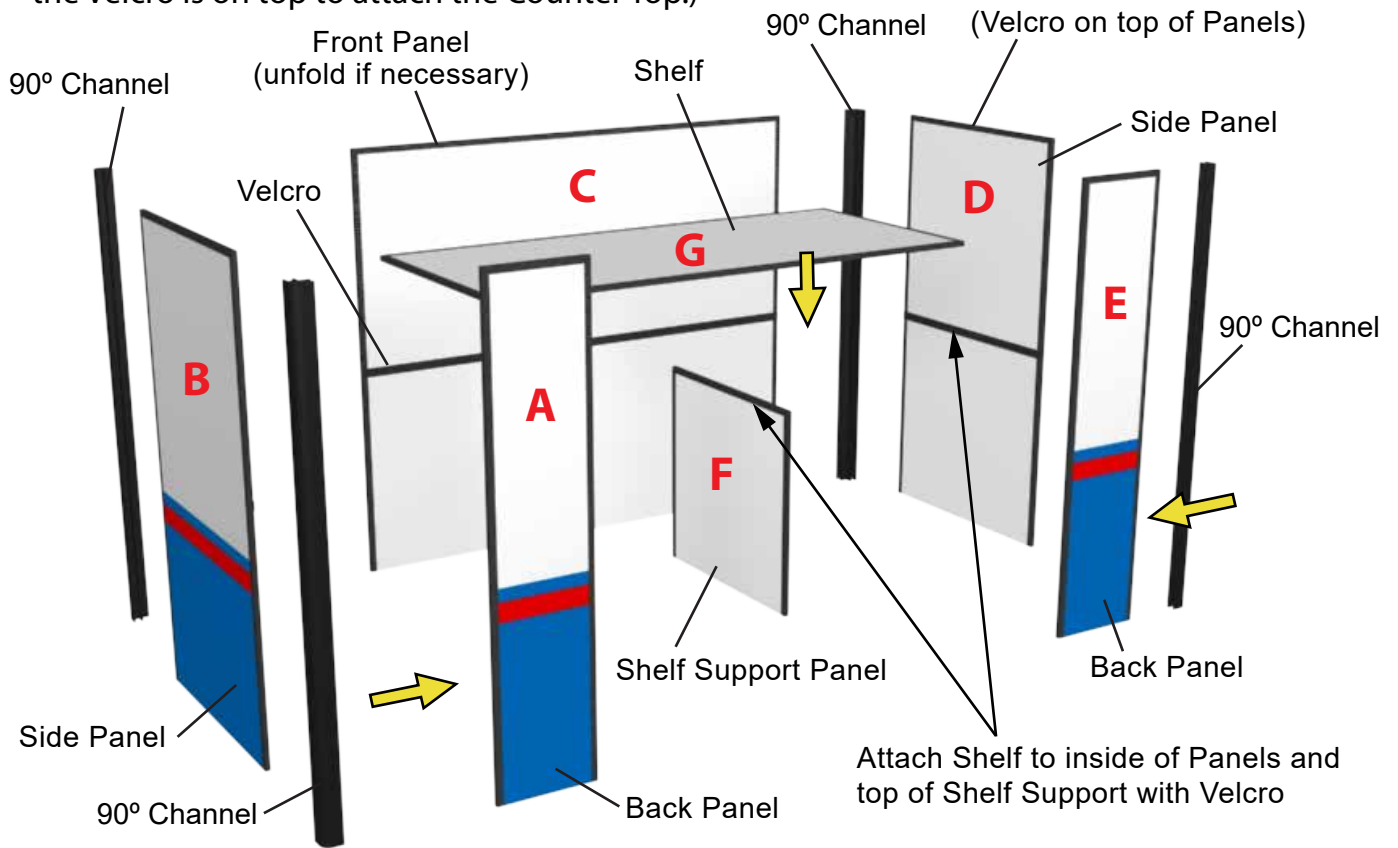

B) Place the Support Bar on top of the Back Panels and attach the Counter Top to the tops of the Panels and Support Bar with Velcro.

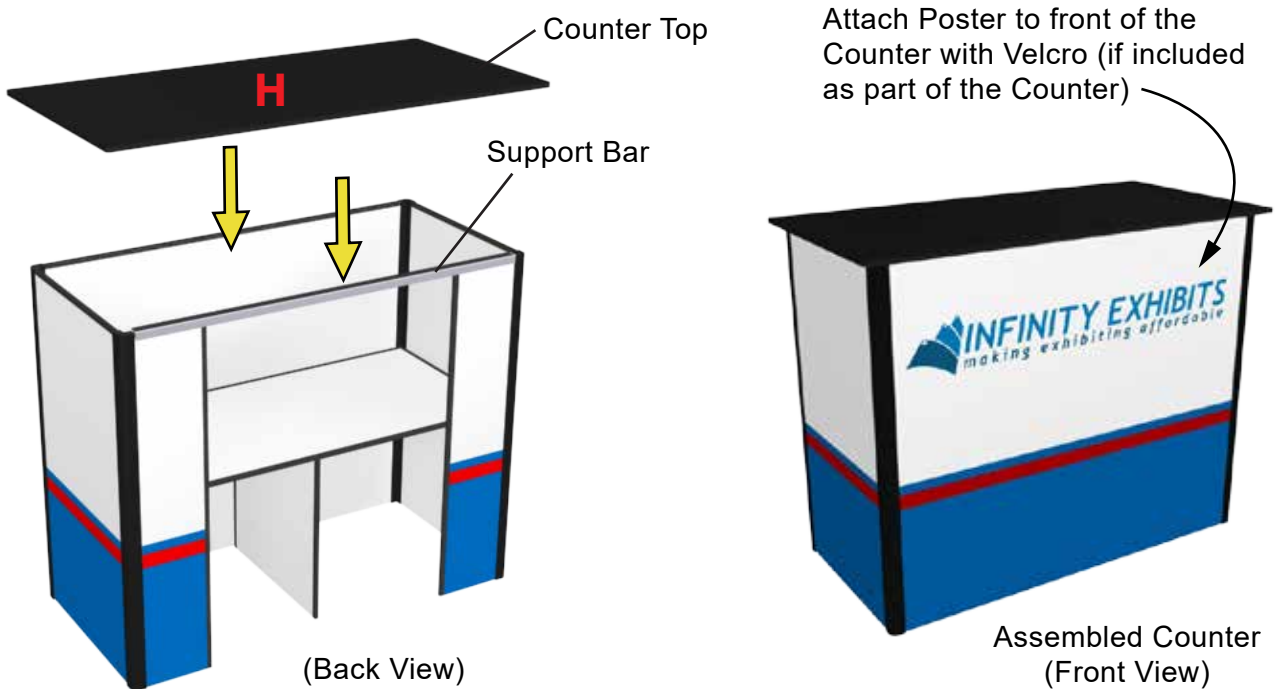

Assembly Instructions: 20' Multi 4 Section Counter & Graphic Display

Attach the Stem Lights to the tops of the Pillars.

A) Place a wooden Light Support Stick on top of the proper Pillars as shown. (Use a ladder or step stool to access the top of the Pillar.) Secure the Stick to the back of the Pillar with a Binder Clip.

B) Attach the Stem Light to the front end of the Pillar and Support Stick by adjusting the thumbscrew on the back of the Stem Light. (**DO NOT** overtighten the thumbscrew. Overtightening the adjustment thumbscrew may damage the Pillar.)

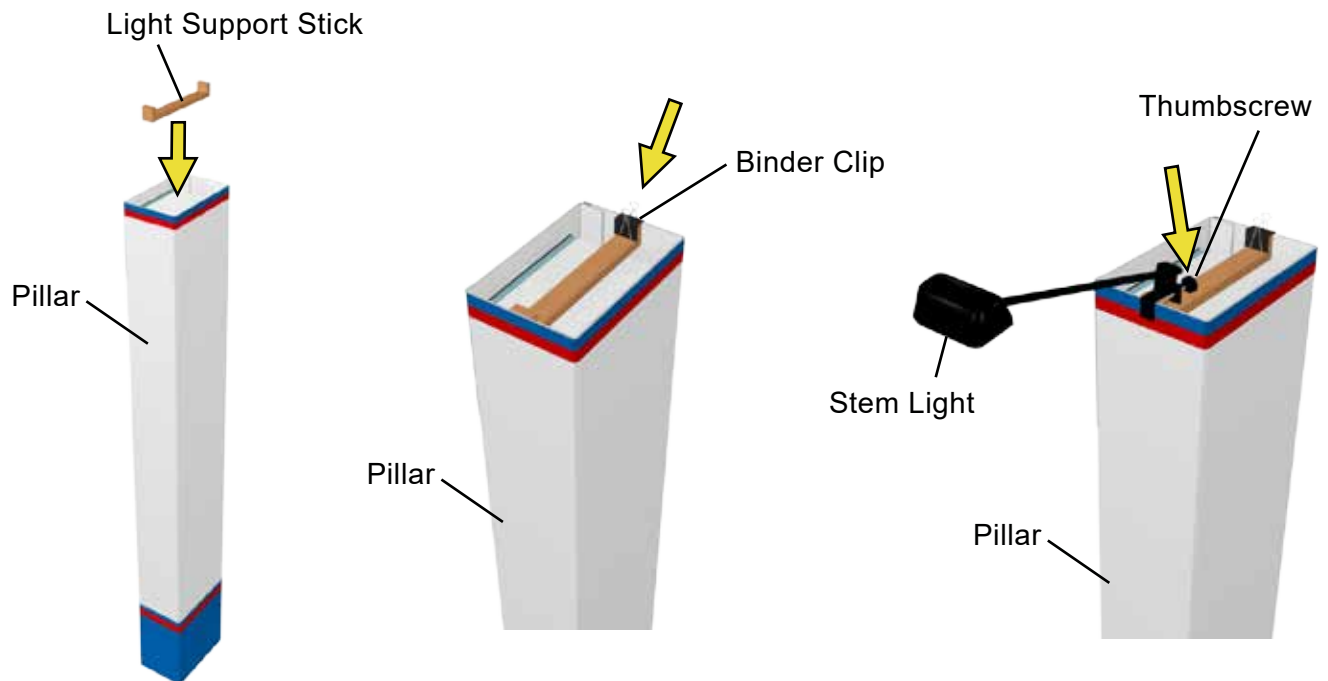

Assembly Instructions: 20' Multi 4 Section Counter & Graphic Display

Case Layout

Divide the booth components and pack them in the tub and case in the following manner:

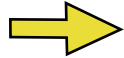

Shipping Cases
(x4)

Case

Booth Components

Case

Booth Components

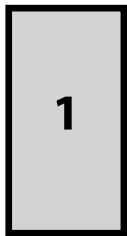

- 1) Pillars
- 2) Tops & Bottoms
- 3) Small Signs



- 1) Front 2x4 counters|
- 2) Light box Frames
- 3) Fabric Graphics

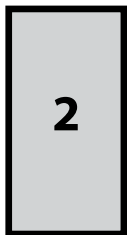

- 1) Wall Panels
- 2) Artwork/Posters



- 1) Backwall Pedistals
- 2) Stem Lights
- 3) Light Support Sticks
- 4) Extension Cords
- 5) Power Strips

NOTE: Pack the heavier components towards the bottom of the Tub and Cases.

9" x 14" Pillar
5

9" Pillar
Top and Bottom Insert
14

44" Wall Panel
4

Small Sign
2

Light Box Panel
2

Fabric Graphic
1

PH1028 @ 36.875" long
8

PH1028 @ 44.25" long
4

In-line Connector
4

M5x10 Machine Screw
8

Small Sign Graphic
2

Counter Front @ 43x40
2

Counter Side @ 15x40
2

Counter Top @ 16.5x44.5
- White
2

Counter Channel - White
20

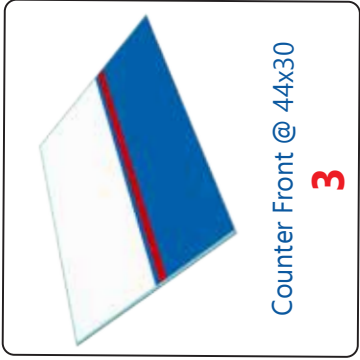

Counter Front @ 44x30
3

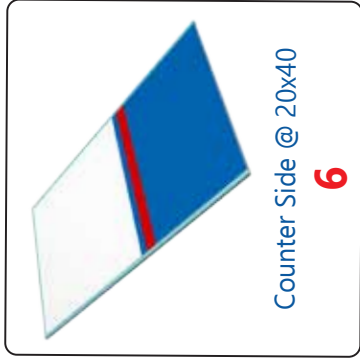

Counter Side @ 20x40
6

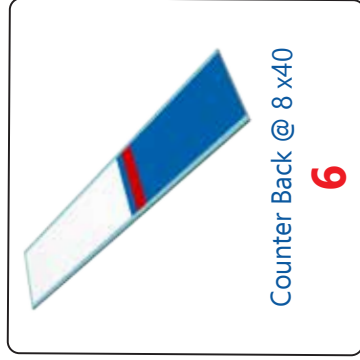

Counter Back @ 8 x40
6

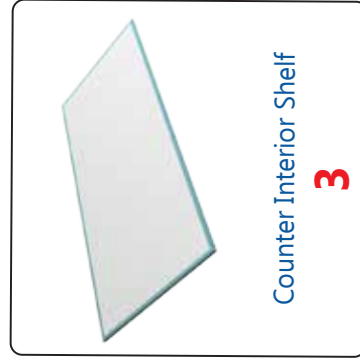

Counter Interior Shelf
3

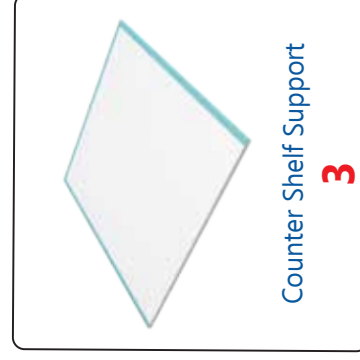

Counter Shelf Support
3

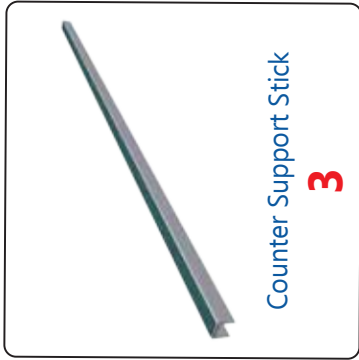

Counter Support Stick
3

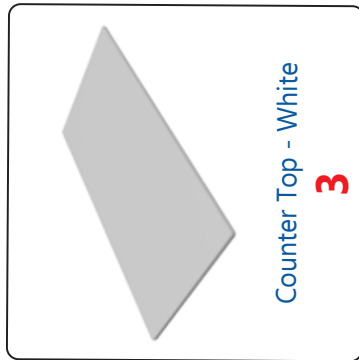

Counter Top - White
3



White Stem Light - SL518
4



Wooden Light Stick
4

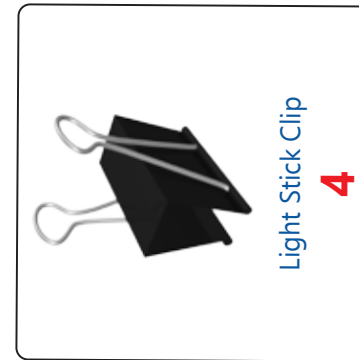

Light Stick Clip
4



Extra Halogen Light Bulb
1

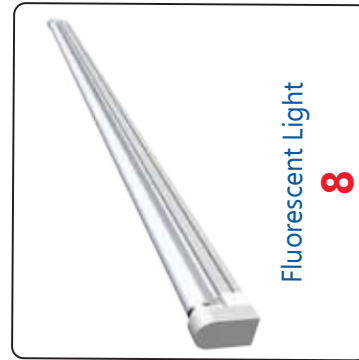

Fluorescent Light
8



Fluorescent Power Cord - 12'
2



Fluorescent Link Cable - 24"
6

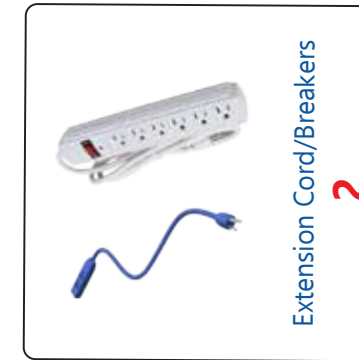

Extension Cord/Breakers
2