



**Steps to Assemble the InfiniLite Multi Section Exhibit Booth:**

- Step 1:** Assemble Short Pillars, Pillar, and Corner Pillars.
- Step 2:** Place Pillars upright in their proper order.
- Step 3:** Attach Wall Panels to Pillars.
- Step 4:** Install Storage Doors.
- Step 5:** Install Shelf Support Bars.
- Step 6:** Attach Shelves to Shelf Support Bars with Velcro.
- Step 7:** Attach Large Sign to Pillars with Velcro.
- Step 8:** Attach Stem Lights to Pillars.

**Assemble Short Pillars.**

A) Unfold the Short Pillar Panels with the front sides facing downward.

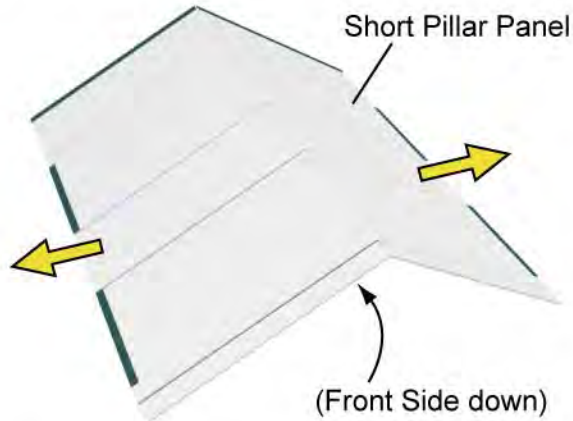

B) Attach Top and Bottom Supports to the back of the Short Pillars with Velcro.

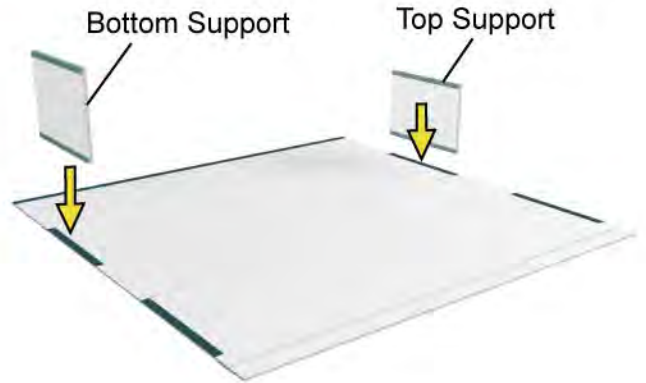

C) Fold Short Pillar around the Top and Bottom Supports and attach with Velcro.



D) Close the Short Pillar using the Velcro strips along the edges.

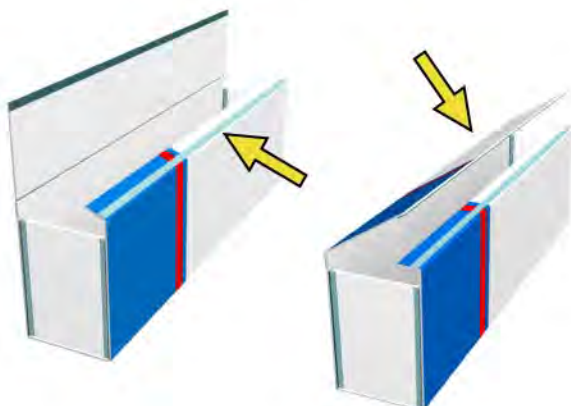

E) Attach Pillar Top to the Short Pillar with Velcro.

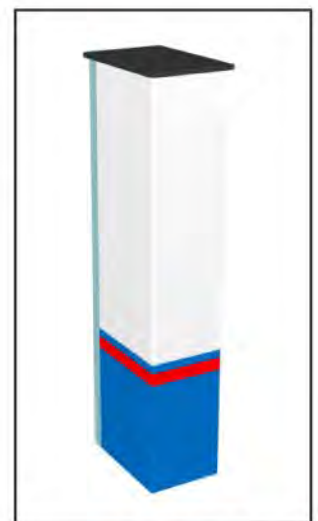
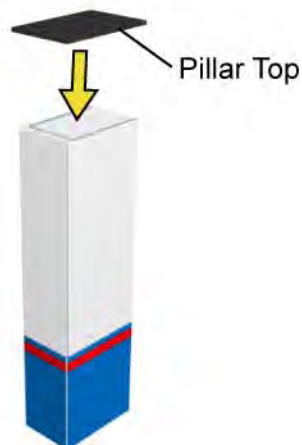

Assembled Short Pillar

**Assemble Pillars.**

A) Unfold the Pillar Panels with the front sides facing downward.

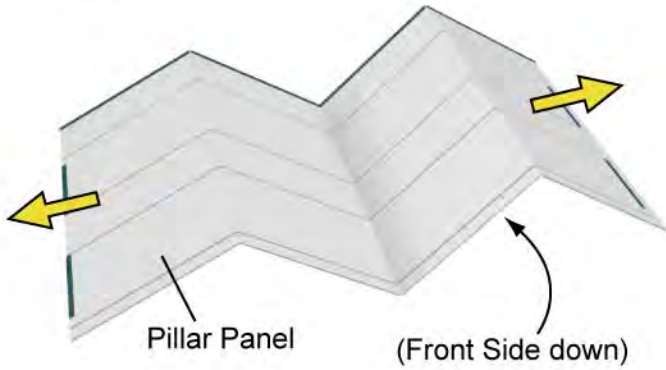

B) Attach Top and Bottom Supports to the back of the Pillars with Velcro.

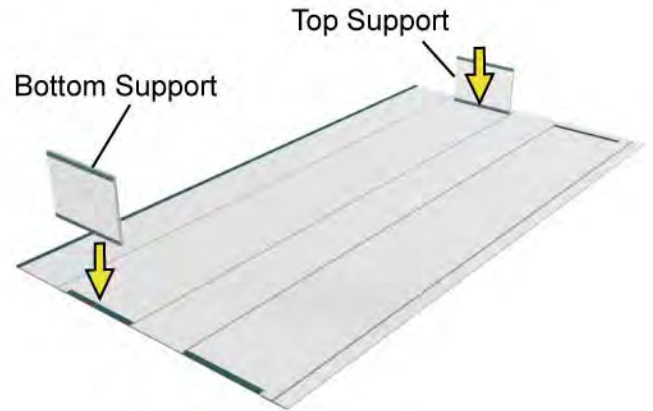

C) Fold Pillar around the Supports and attach with Velcro.

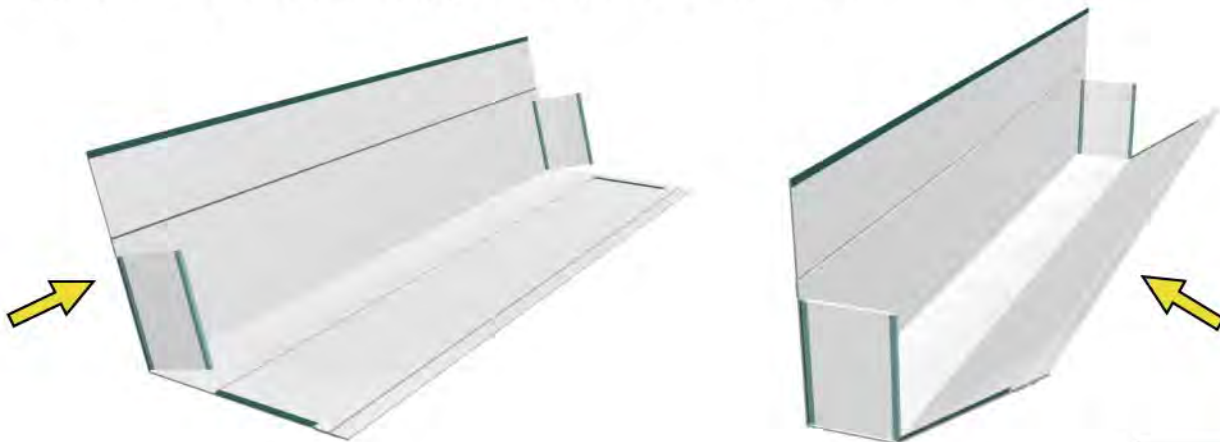

D) Close the Pillar using the Velcro strips along the Pillar edges.

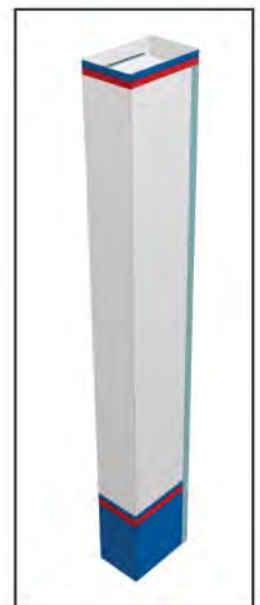
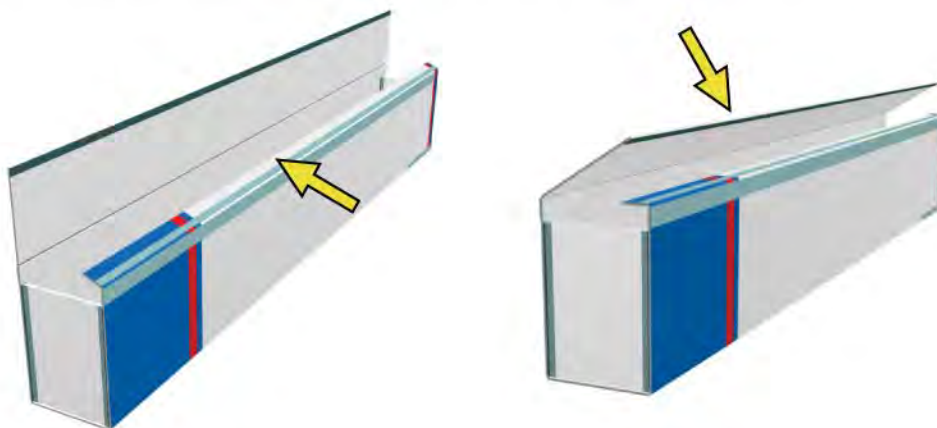

Assembled Pillar

**Assemble Corner Pillars.**

E) Unfold the Corner Pillar Panels with the front sides facing downward.

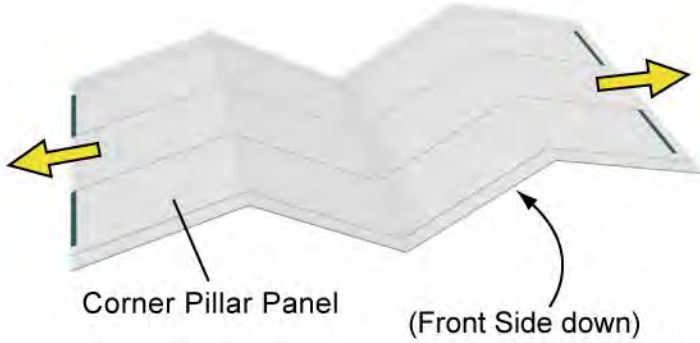

F) Attach Top and Bottom Supports to the back of the Corner Pillars with Velcro.

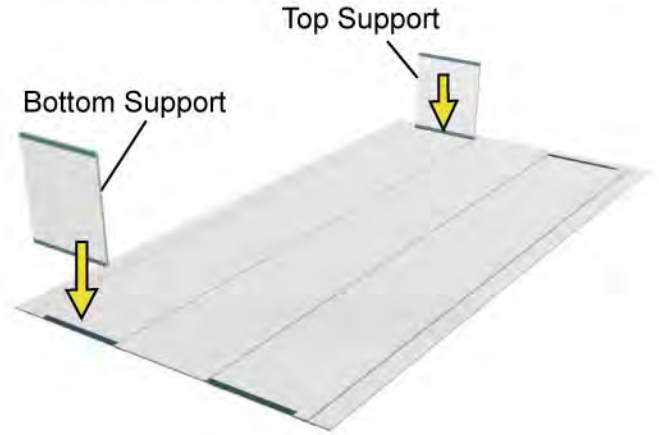

G) Fold the Corner Pillar around the Supports and attach with Velcro.



H) Attach the Back Cover to the bottom half of the Corner Pillar with Velcro; unfold the Back Cover; then attach the remaining Back Cover to the upper half of the Corner Pillar.

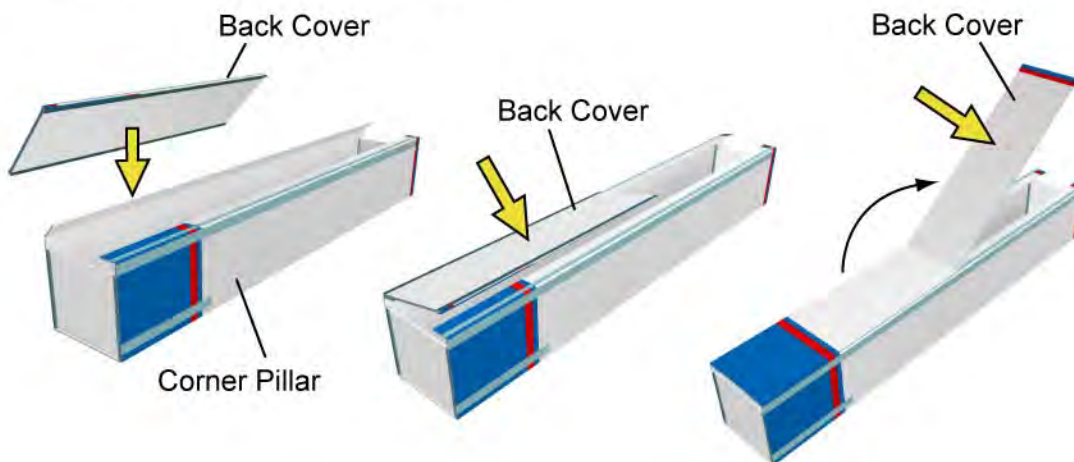

## Assembly Instructions: 10' Multi 4 Section Short Wall Shelf Display

Place Pillars upright in their proper order.

A) The following Floor Plan identifies the locations of the Booth Components:

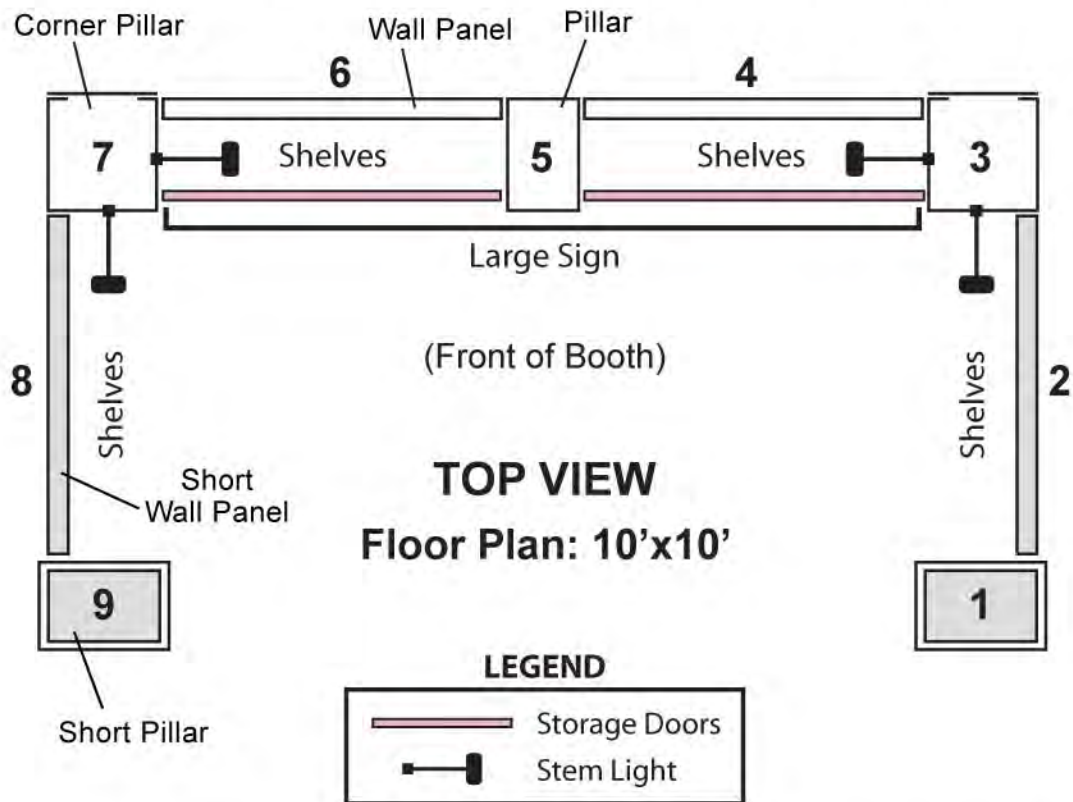

B) Place the assembled Pillars in their assigned locations as numbered and indicated on the Floor Plan.

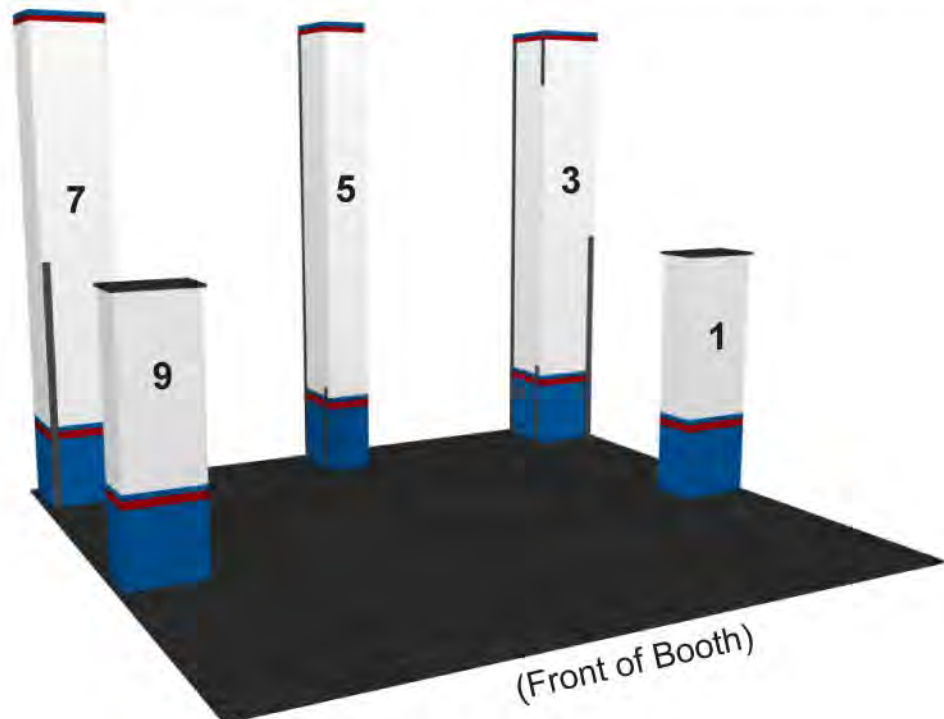

**Attach Wall Panels to Pillars.**

A) Unfold the bottom half of the Wall Panel, hold upright and attach to the side of the Pillar with Velcro. (Make sure that the Pillar and Wall Panel are **flat** on the floor surface when attaching and that the accent stripes are aligned with each other.) Begin assembly from either the left or right side of the Booth.

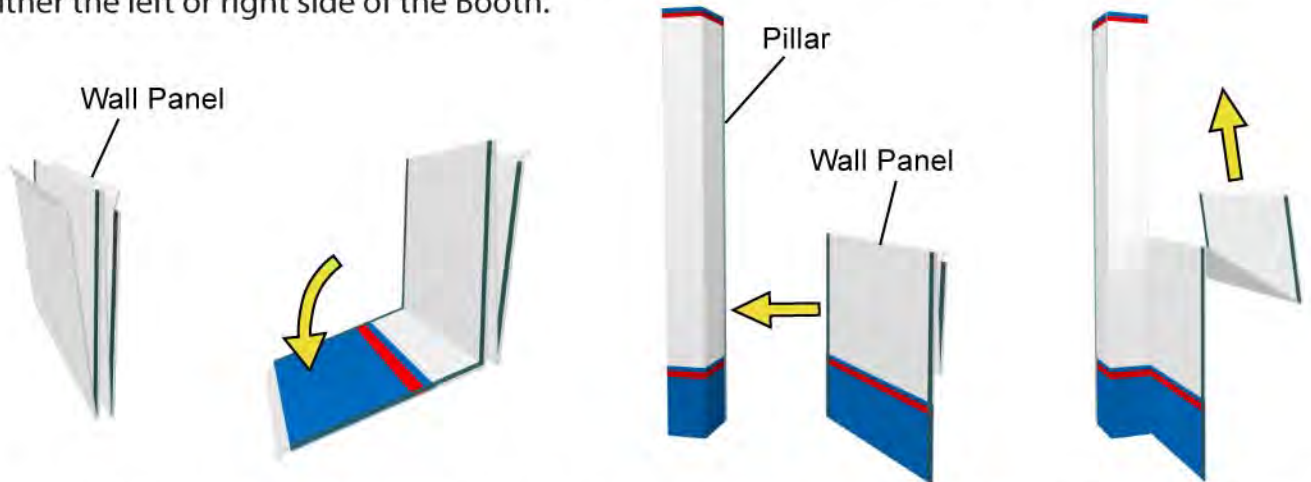

B) Unfold the top half of the Wall Panel and attach it to the top half of the Pillar matching the Velcro strips along the edges. Rotate the Wall Panel into position. Attach the next Pillar to the Wall Panel so that it is flat against the front face of the Wall Panel. Rotate the Pillar into position.

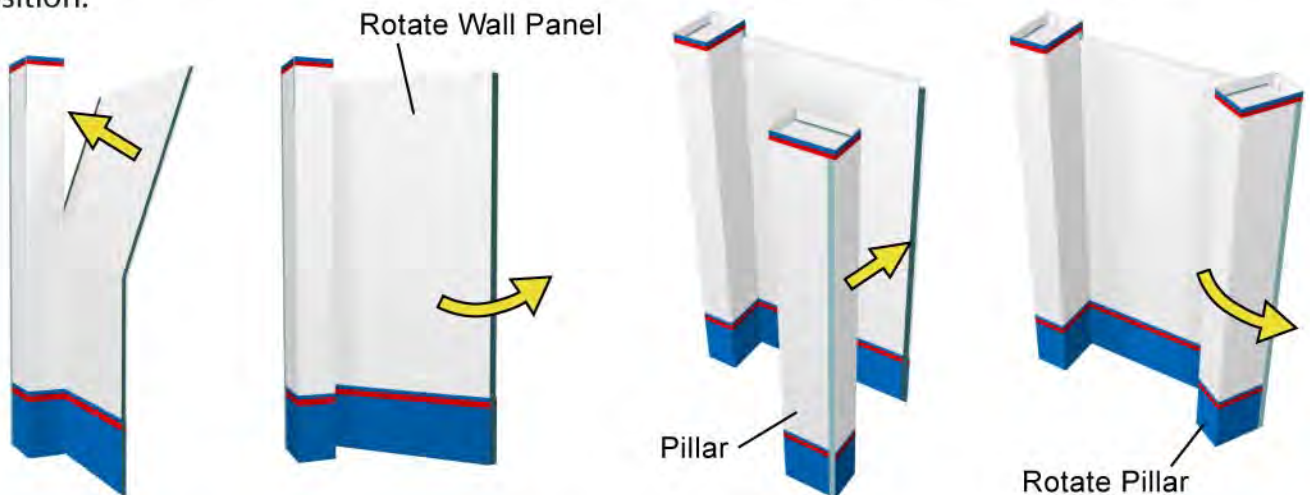

C) Repeat this process with the remaining Wall Panels and Pillars.



**Attach Short Wall Panel to Pillars.**

A) Unfold the Short Wall Panel, hold upright, and attach to Pillar with Velcro. (Make sure that the bottoms of the Pillar and Short Wall Panel are **flat** against the floor when attaching and that the accent stripes are aligned with each other.)

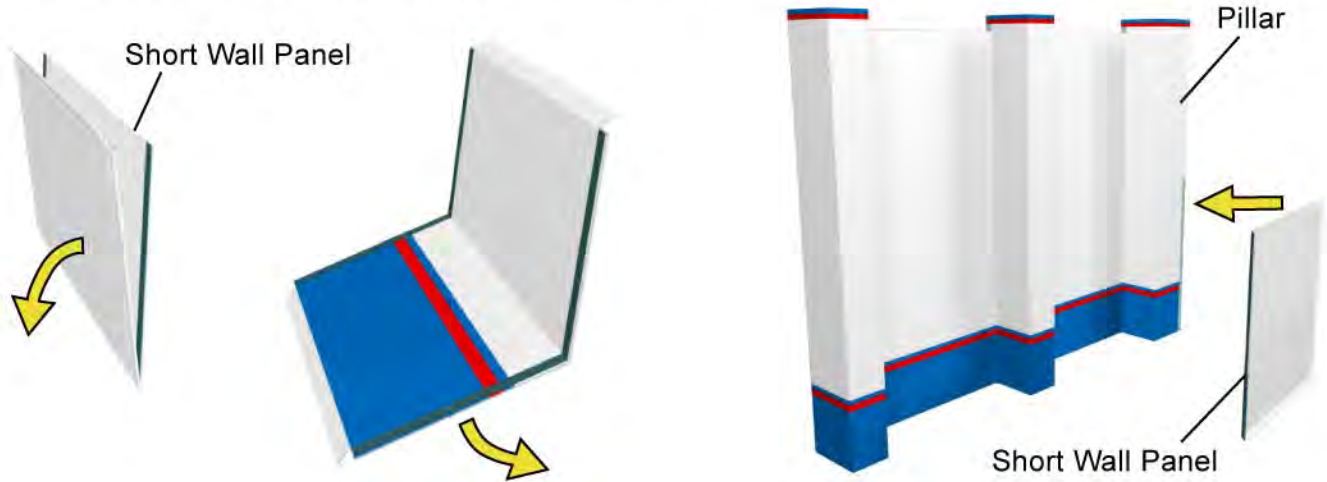

B) Rotate the Short Wall Panel into position. Attach the Short Pillar to the Short Wall Panel so that it is flat against the front face of the Short Wall Panel. Rotate the Pillar into position.

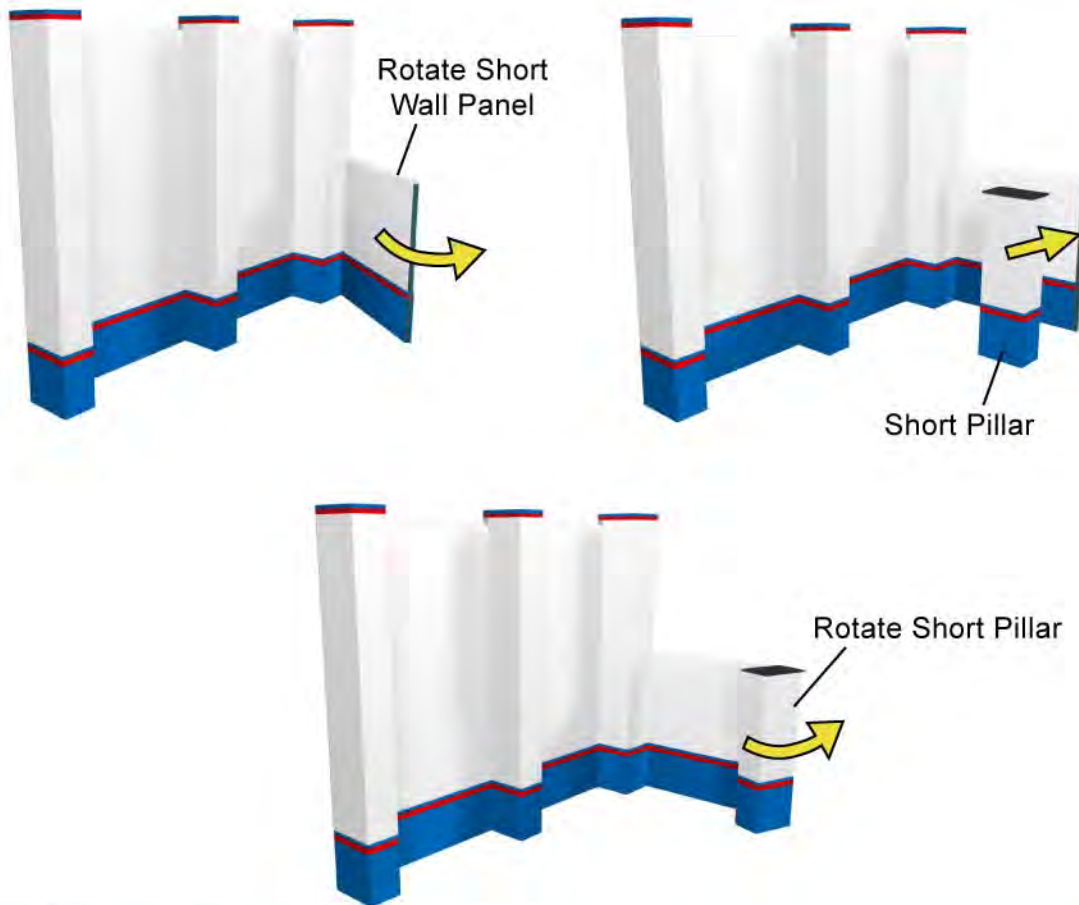

## Assembly Instructions:

# 10' Multi 4 Section Short Wall Shelf Display

Install Storage Doors. (Attach Storage Doors to Pillars with Velcro.)



Install Shelf Support Bars.

A) Insert the shelf support bars into their designated openings in the Pillars with the **back bars** first, installing from the bottom upward. Then install the **front bars** from the bottom upward.

Make sure that the **Velcro on the bars is facing up** to attach the shelves and that the full portion of the **vinyl covering** is facing forward (if vinyl has been applied to the front of the shelf support bar).

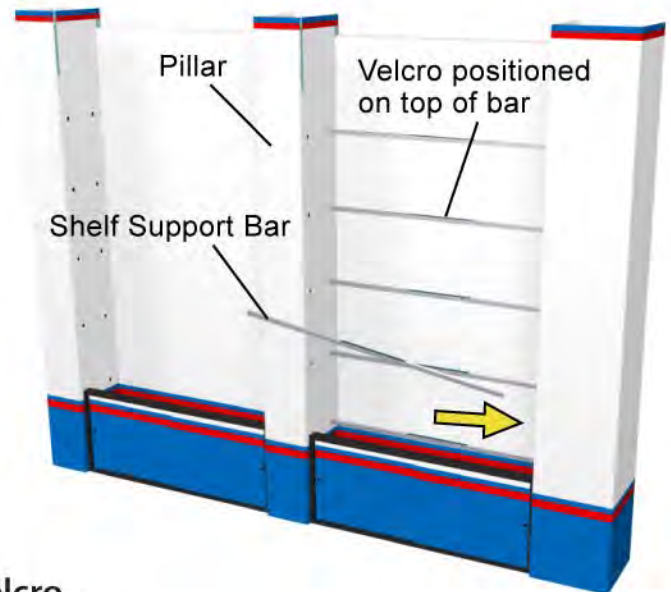

Attach Shelves to Shelf Support Bars with Velcro.

A) Place the Shelves on top of the Shelf Support Bars and attach with Velcro.

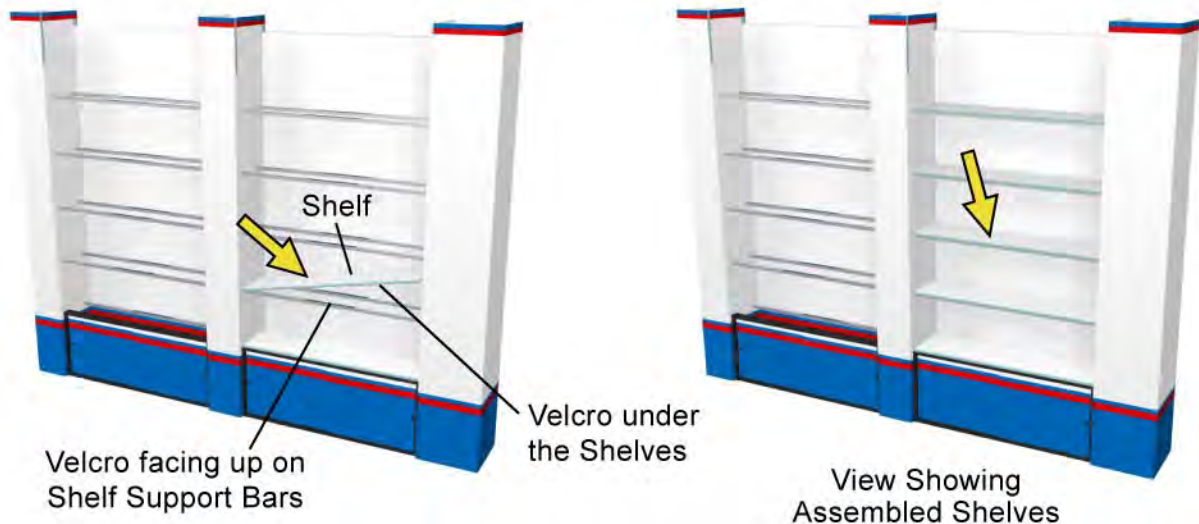



## Assembly Instructions:

## 10' Multi 4 Section Short Wall Shelf Display

Assemble Large Sign and attach to Pillars with Velcro.

A) Unfold the Large Sign.



B) Fold down the top sections of the Sign along the flutes to form a triangle and Velcro closed.

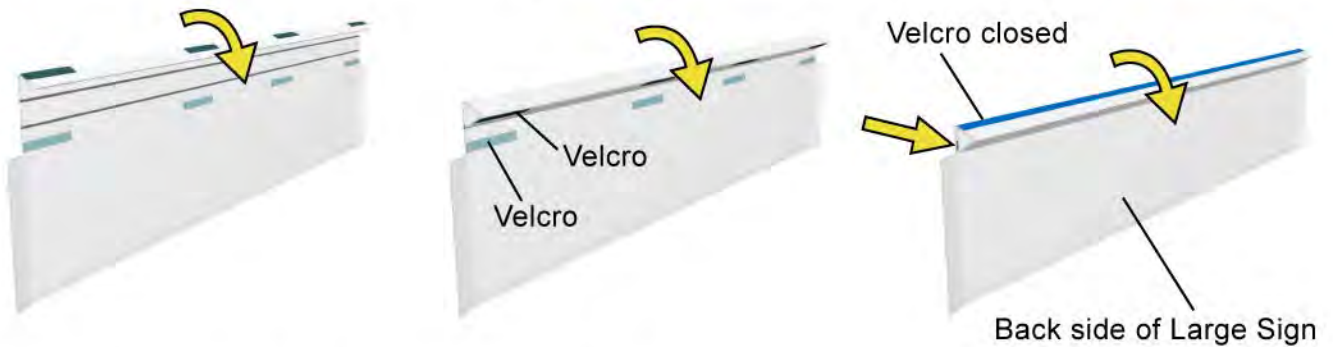

C) Attach Large Sign to Corner Pillars with Velcro.

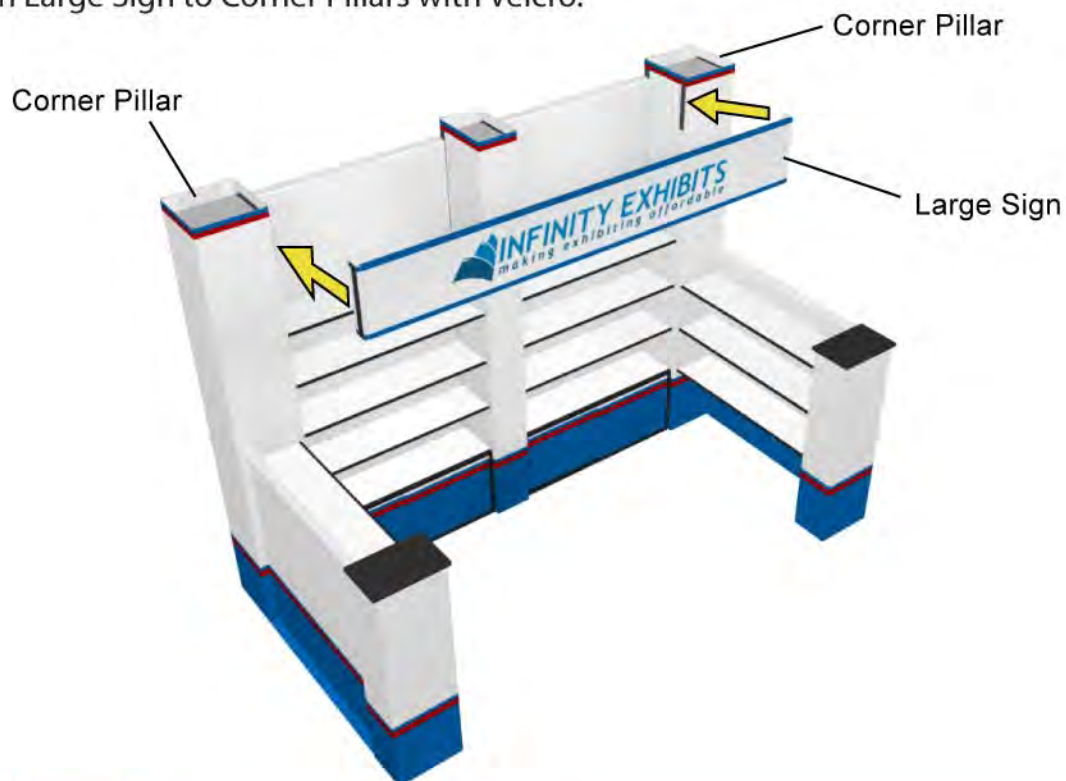

**Attach the Stem Lights to the tops of the Pillars.**

- A) Place a wooden Light Support Stick on top of the proper Pillars as shown. (Use a ladder or step stool to access the top of the Pillar.) Secure the Stick to the back of the Pillar with a Binder Clip.
- B) Attach the Stem Light to the front end of the Pillar and Support Stick by adjusting the thumbscrew on the back of the Stem Light. (**DO NOT** overtighten the thumbscrew. Overtightening the adjustment thumbscrew may damage the Pillar.)

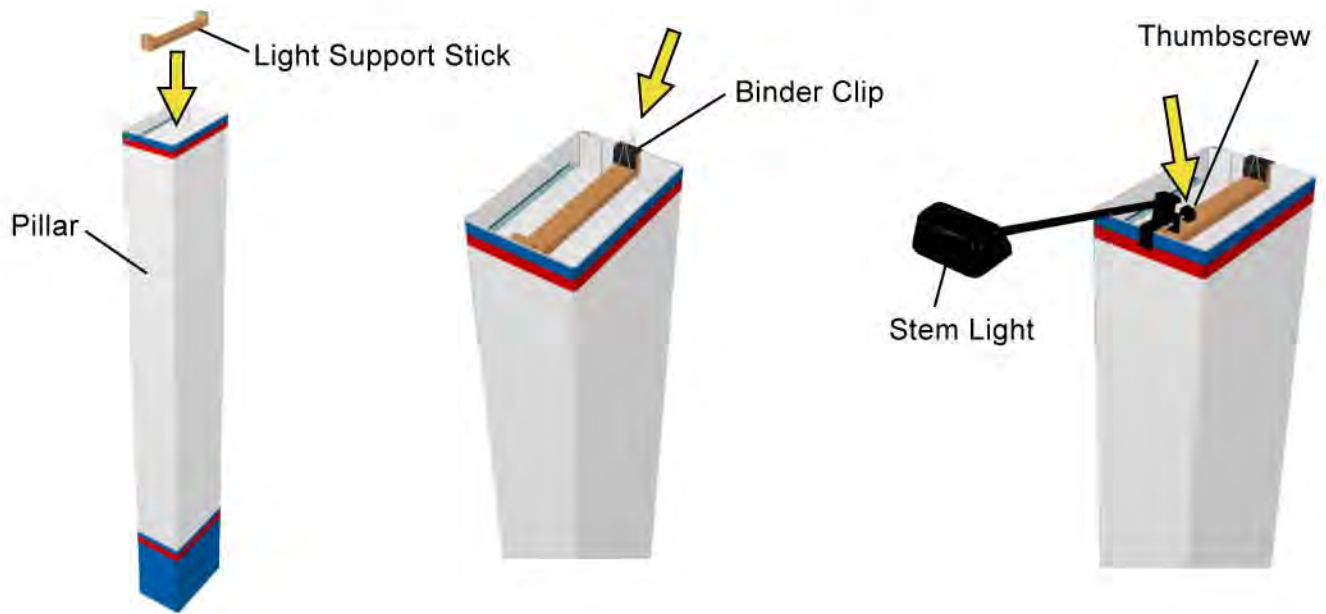

- C) Lights may be mounted in different ways depending on how the Booth is configured.

