

STEPS

(1) Hardware

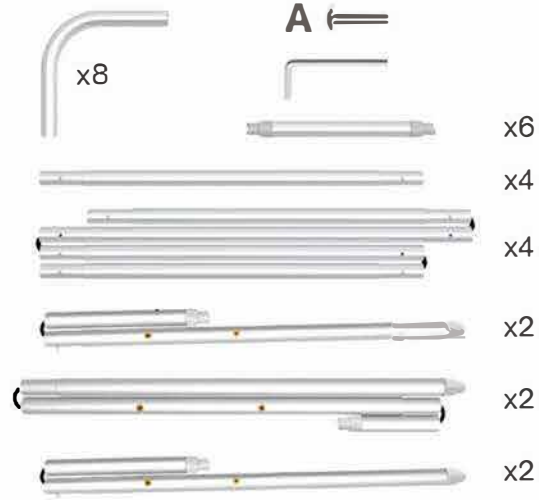

(2) Printed Graphic Fabric Banner (Optional)



STEP 01

To connect the poles according to the labellings

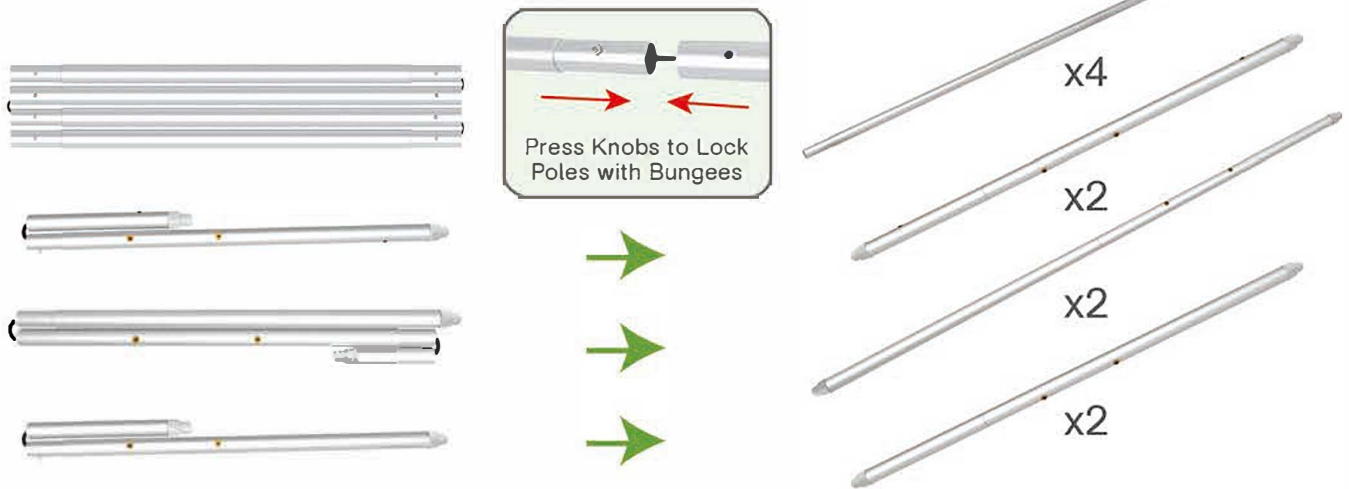

STEP 02

Connect long poles with corner poles according to labellings.

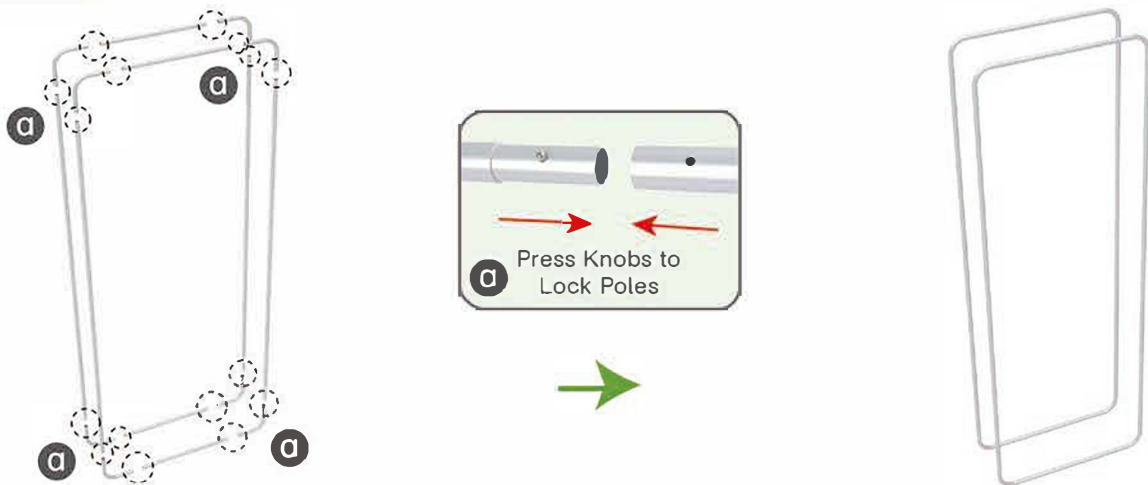

STEPS

STEP 03 Connect support poles onto column frame.

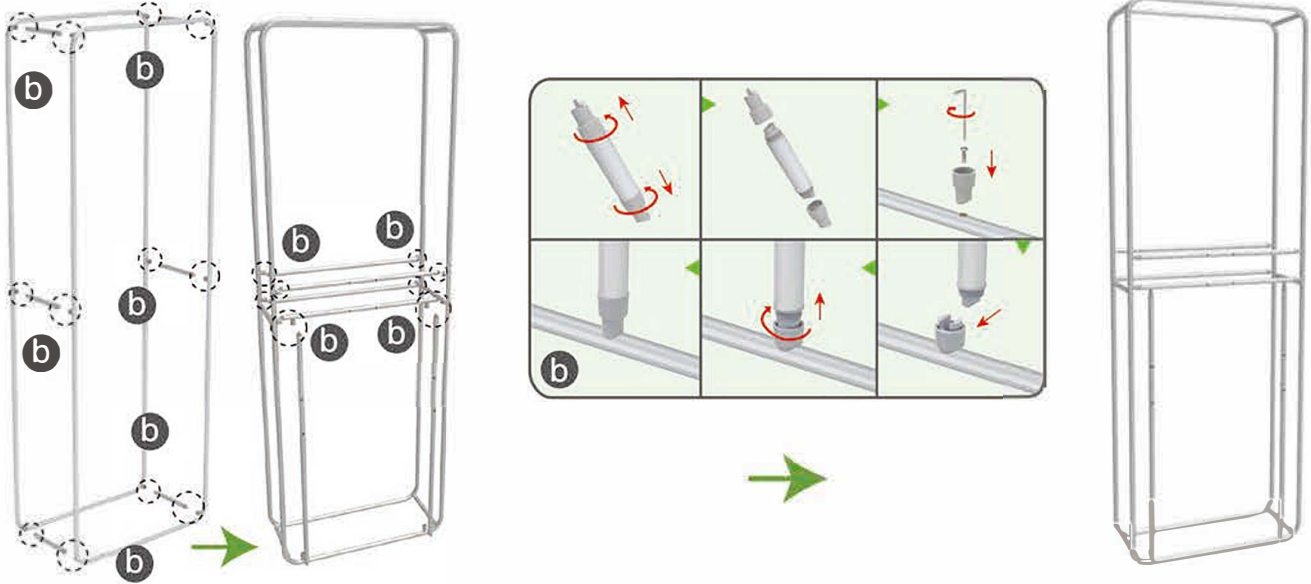

STEP 04 Slide fabric banner on frame from top and zip up at bottom.

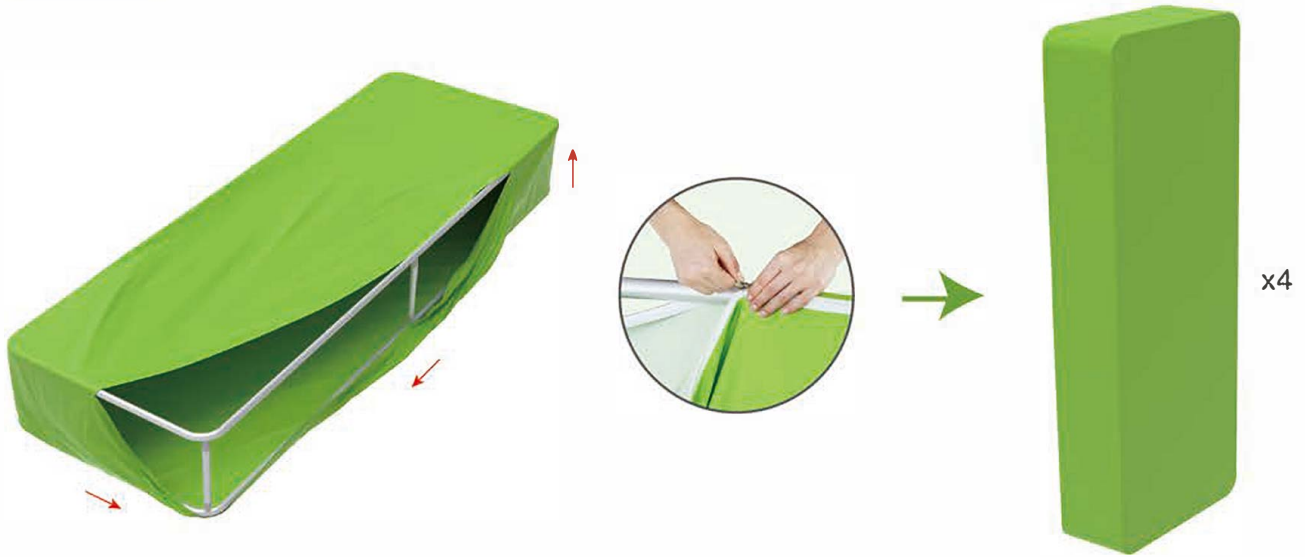

(1) Hardware

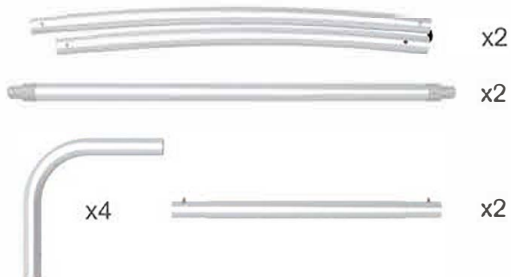

(2) Printed Graphic Fabric Banner (Optional)



STEPS

STEP 01 Connect to make long poles according to labelings.

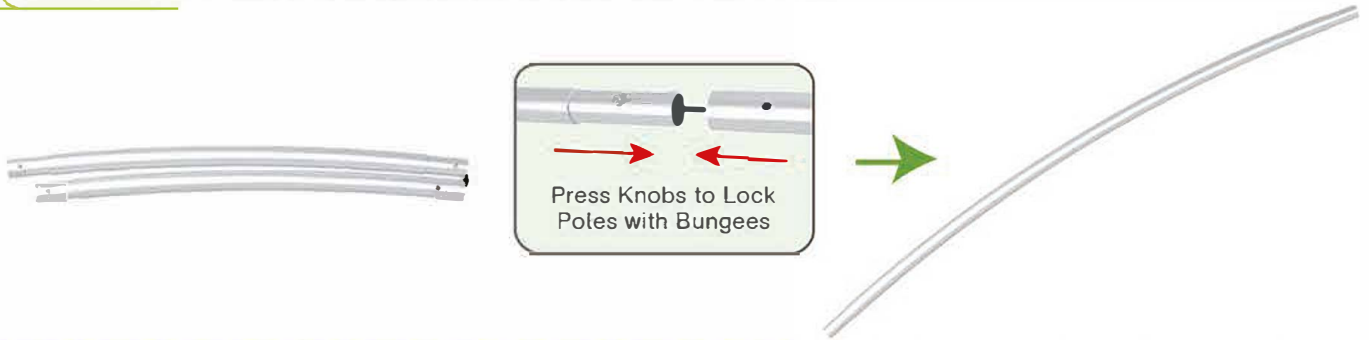

STEP 02 Connect long poles with corner poles according to labelings.

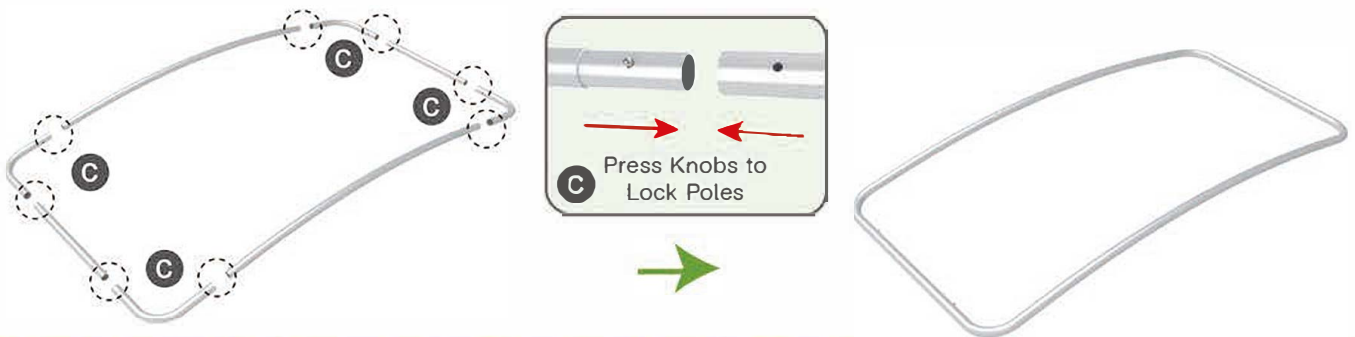

STEP 03 Connect support poles onto frame.

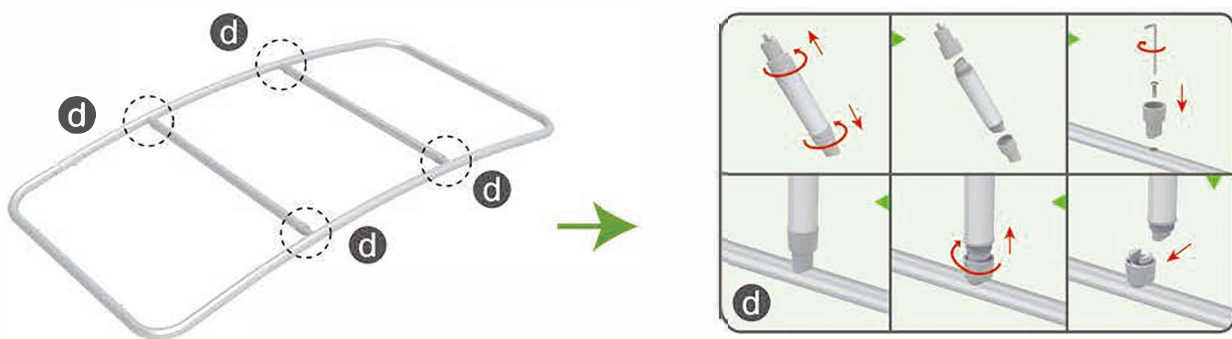

STEP 04 Slide fabric banner on frame from left and zip up at right.



Same Steps for Other Display Stands

STEPS

Booth Set Assembly

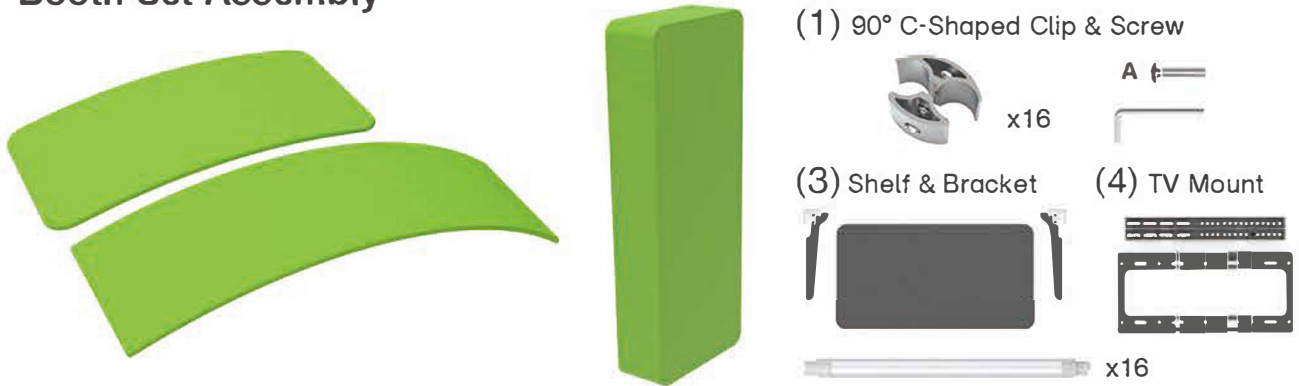

STEP 01 Connect support poles onto column frame and canopy.

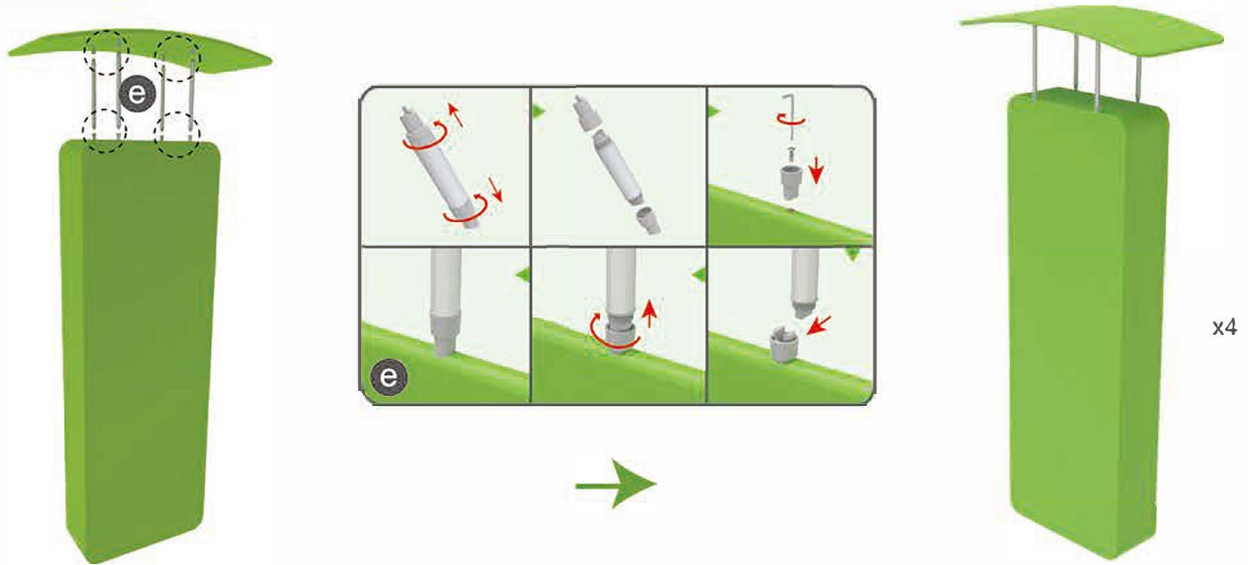

STEP 02 Interconnect display stands with C-shaped clips.



STEPS

STEP 03

Screw brackets onto display stand with hex wrench, insert shelves into slots.

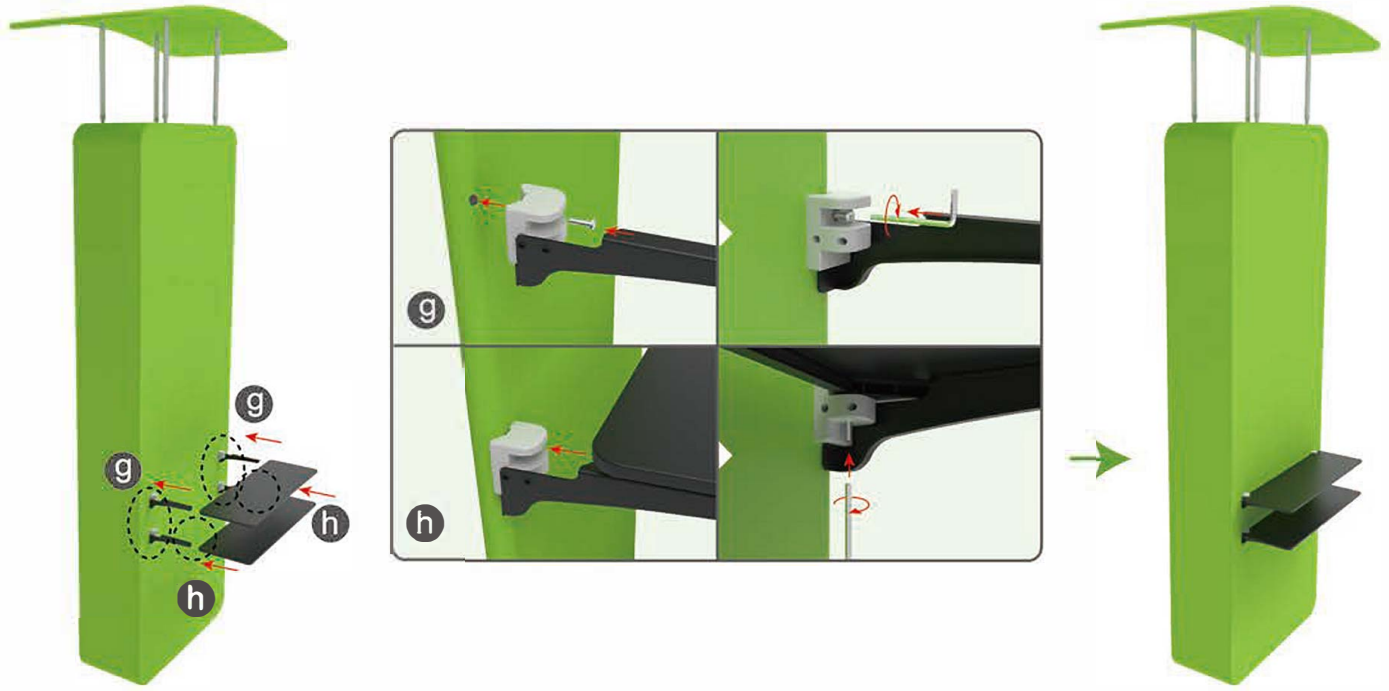

STEP 04

Screw TV mount onto display stand & support brackets onto TV's back with hex wrench, hang TV onto mount & screw.

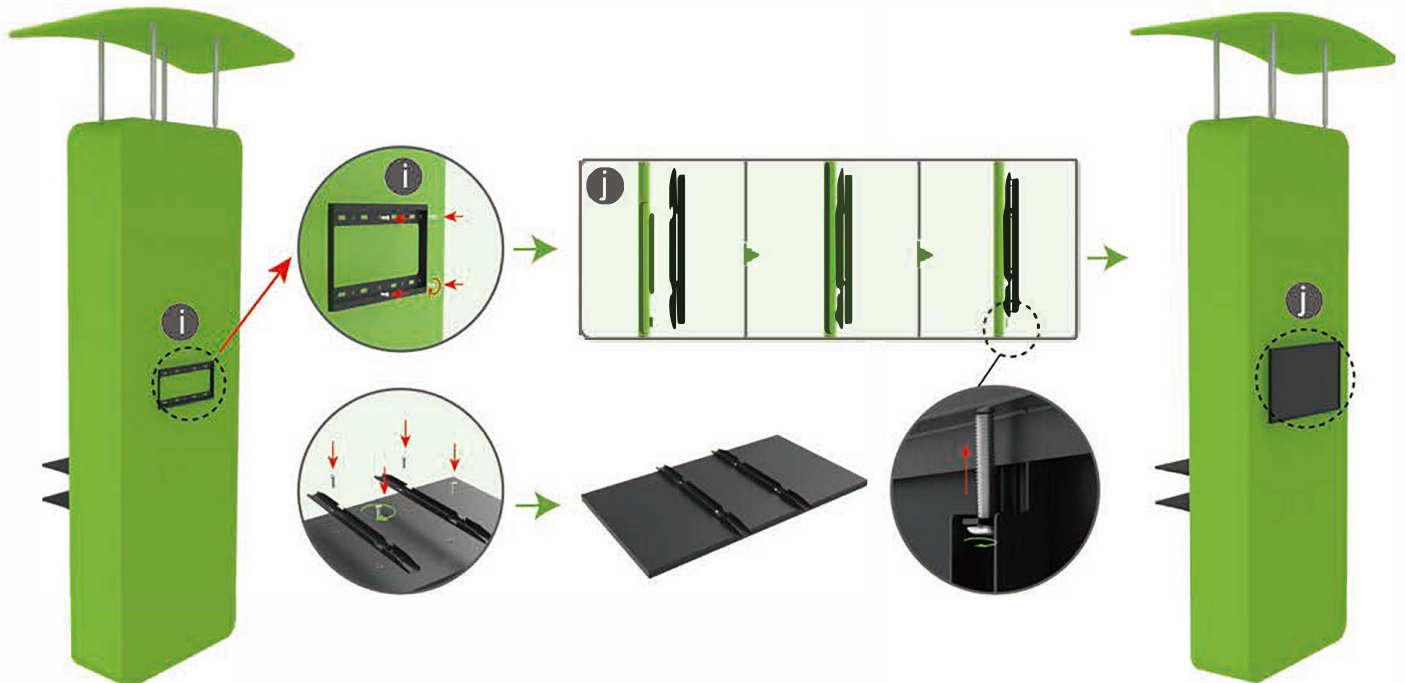

STEPS



20X20FT-BOOTH-07