

★ One Tool (Hex Wrench)

STEPS

(1) Hardware



(2) Screw A, Screw B, Wire with Hook

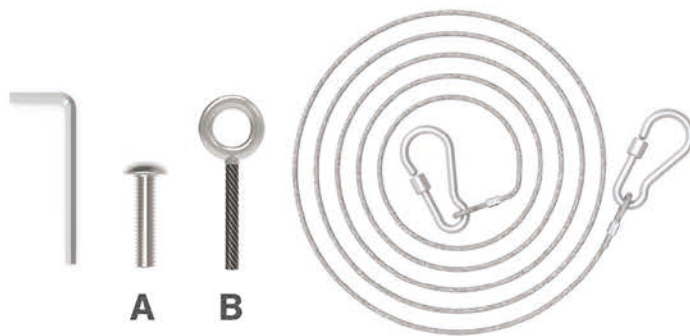

(3) Printed Graphic Fabric Banner (Optional)



STEP 01

Connect to make long poles according to labelings.

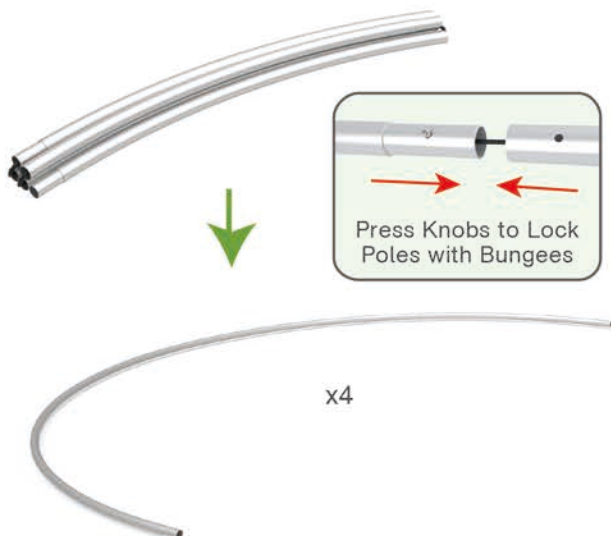

STEP 02

Connect long poles to make frame according to labelings.

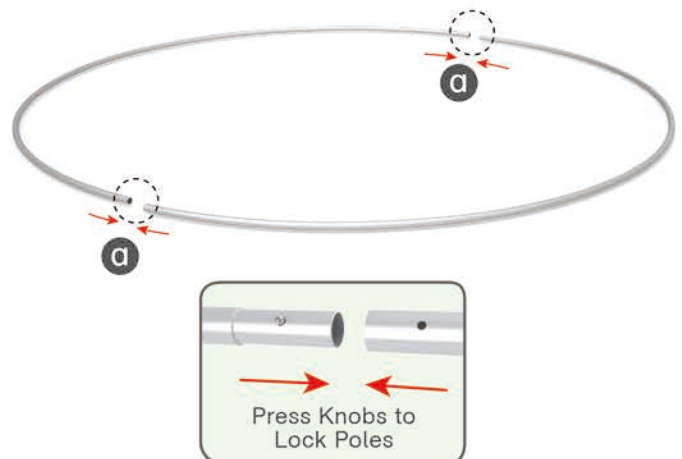

STEPS

STEP 03

Connect support poles onto frame with screws B at top & screws A at bottom.

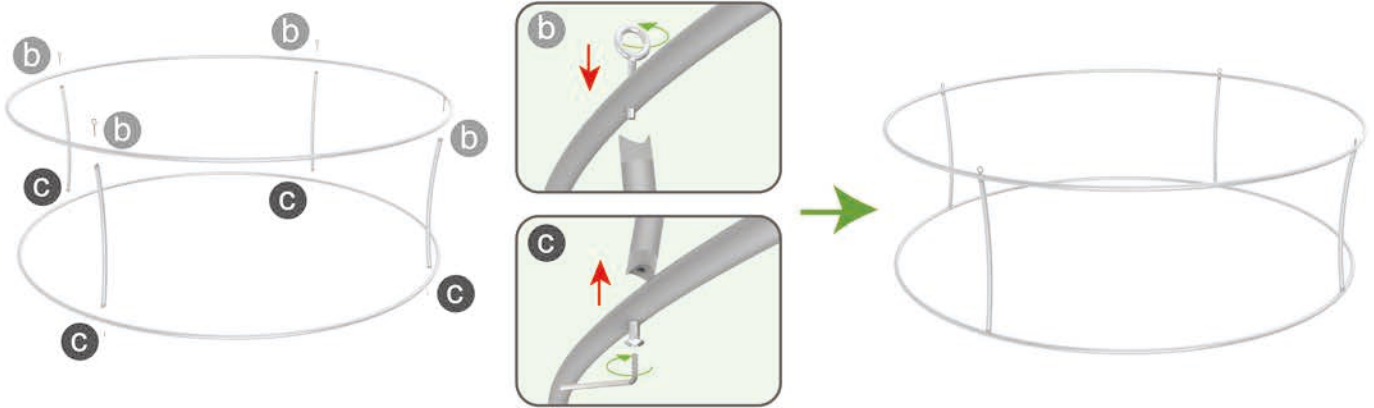

STEP 04

Slide fabric banner on frame from bottom and zip up at top.



STEP 05

Connect screws B by wires with hooks.

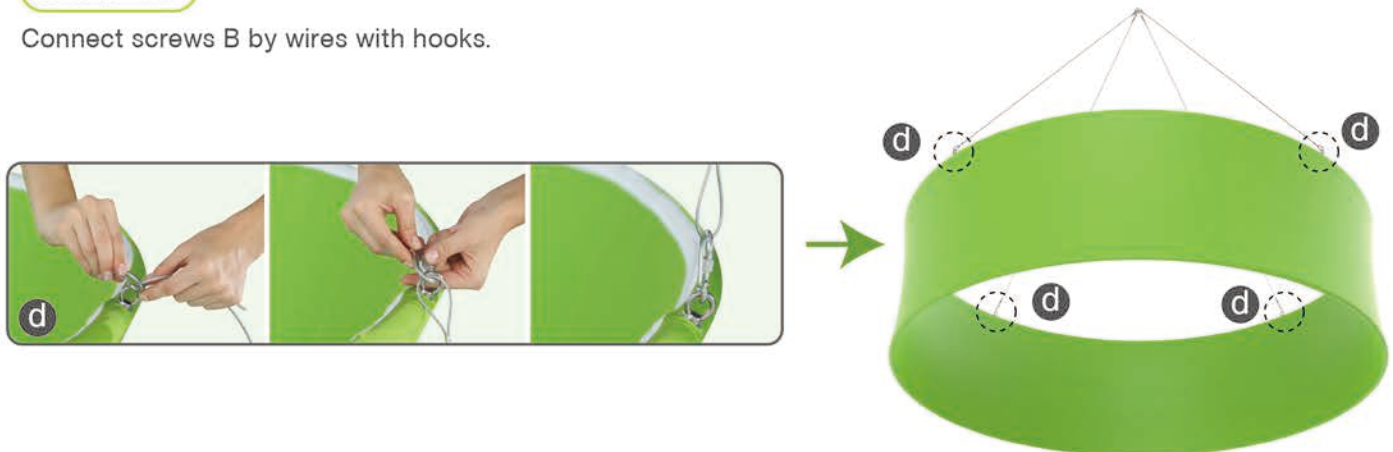

STEPS

(1) Hardware

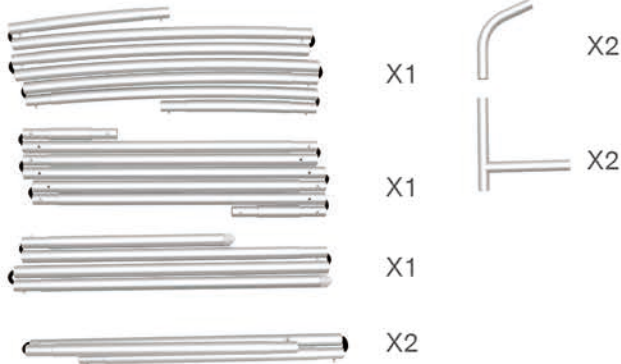

(2) Printed Graphic Fabric Banner (Optional)



STEP 01

Connect to make long poles according to labelings.

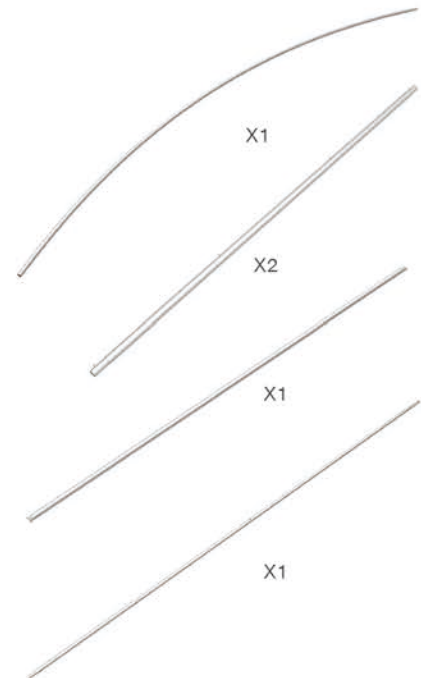
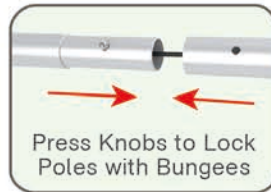
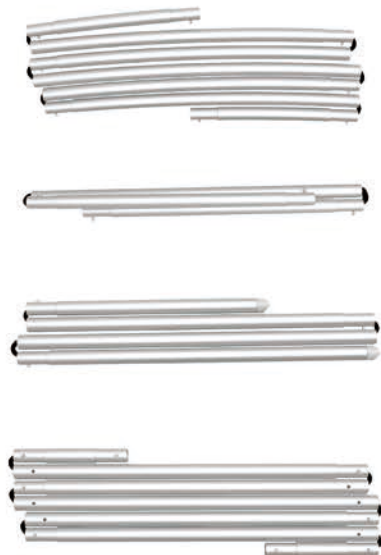

STEP 02

Connect long poles with corner poles according to labelings, connect support pole onto frame.

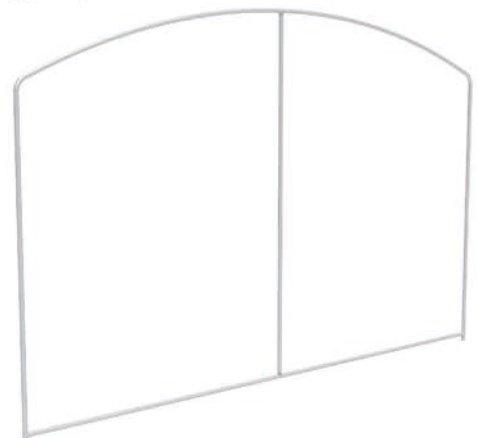
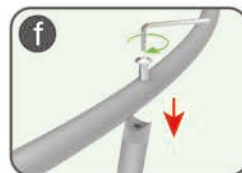
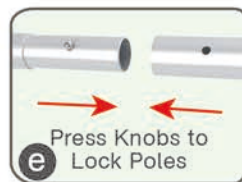
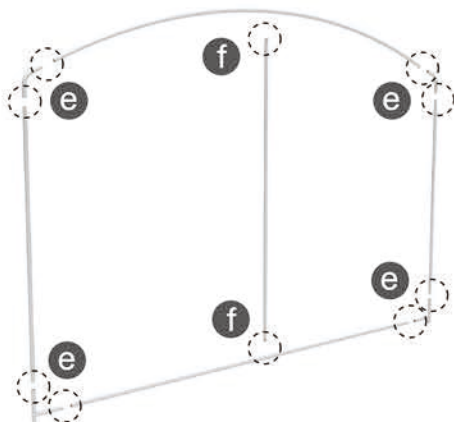

STEPS

STEP 03

Slide fabric banner on frame from top and zip up at bottom.

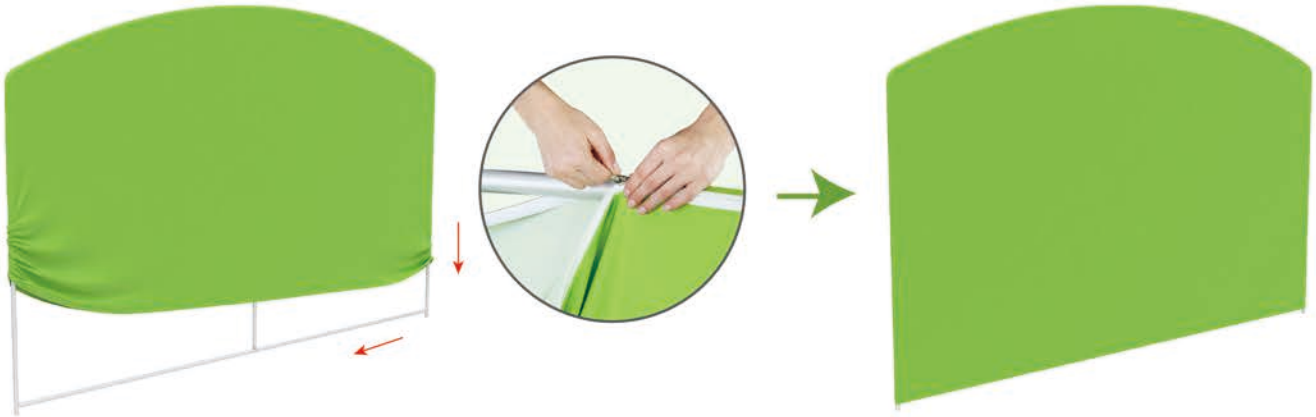

(1) Hardware

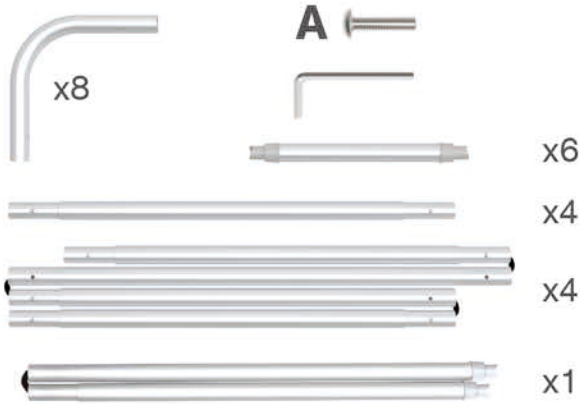

(2) Printed Graphic Fabric Banner (Optional)



STEP 01

Connect to make long poles according to labelings.

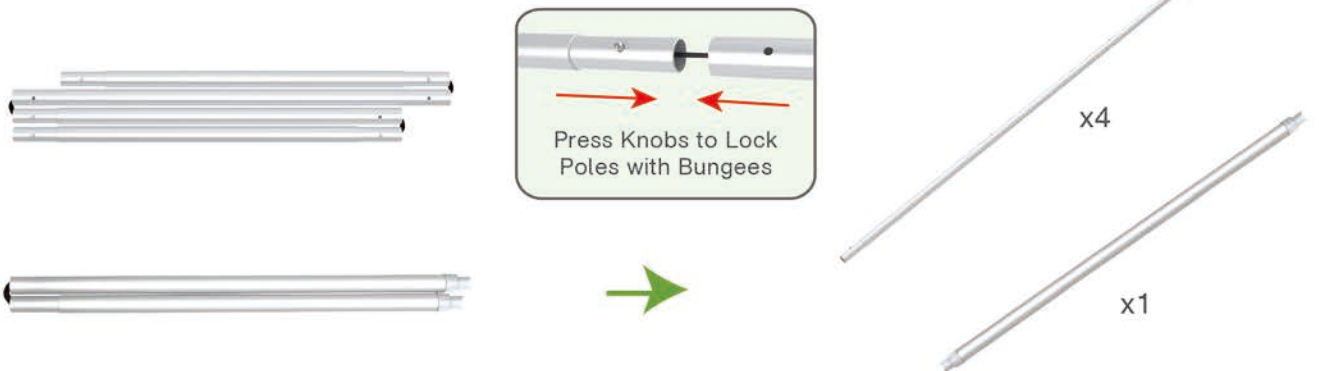

STEPS

STEP 02 Connect long poles with corner poles according to labelings.

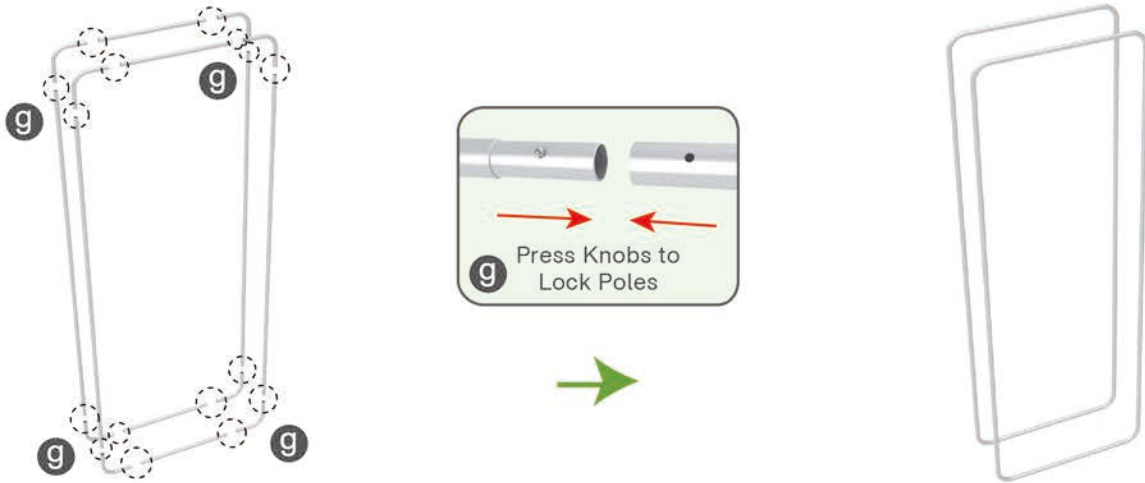

STEP 03 Connect support poles onto column frame.

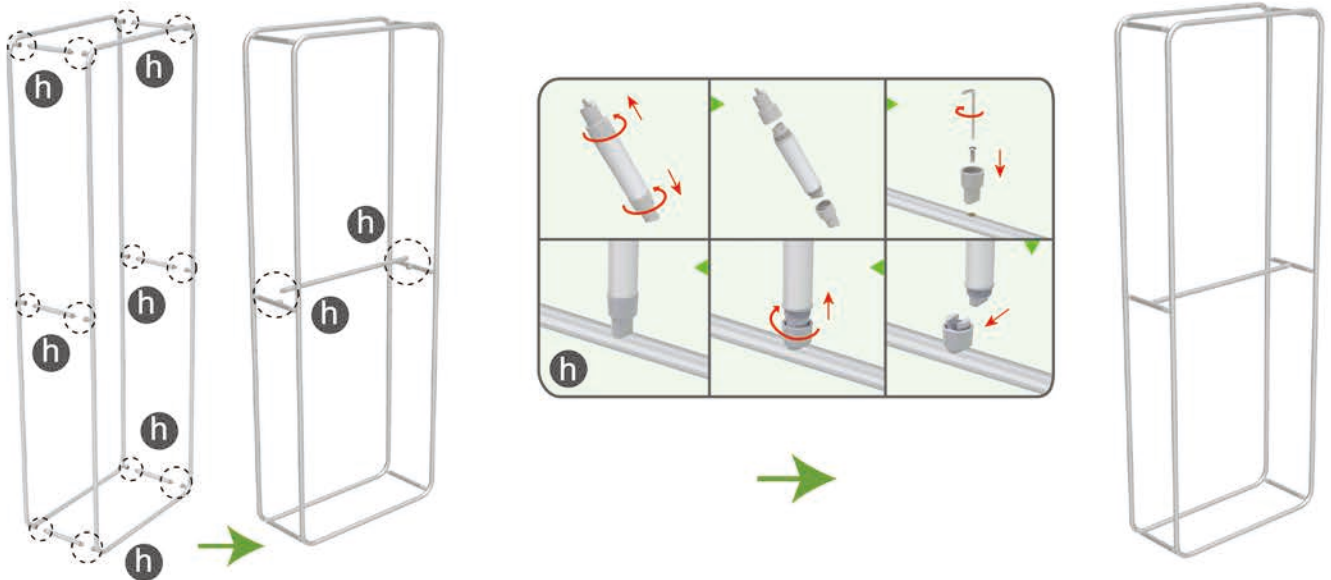

STEP 04 Slide fabric banner on frame from top and zip up at bottom.



STEPS

(1) Hardware



(2) Printed Graphic Fabric Banner (Optional)



STEP 01 Connect to make long poles according to labelings.

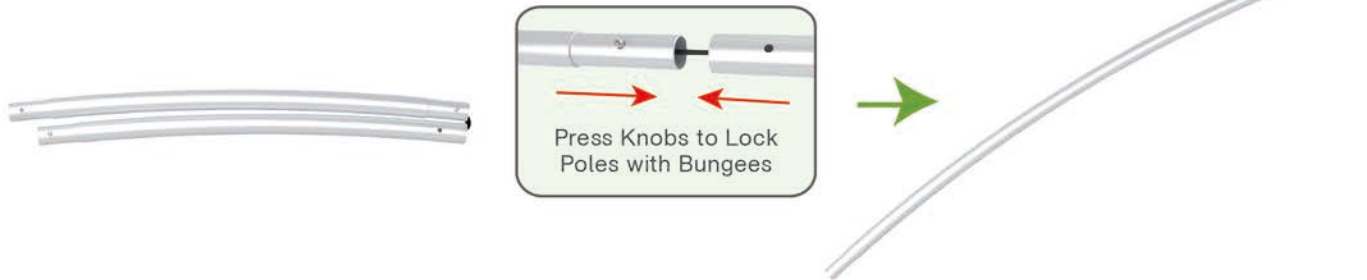

STEP 02 Connect long poles with corner poles according to labelings.

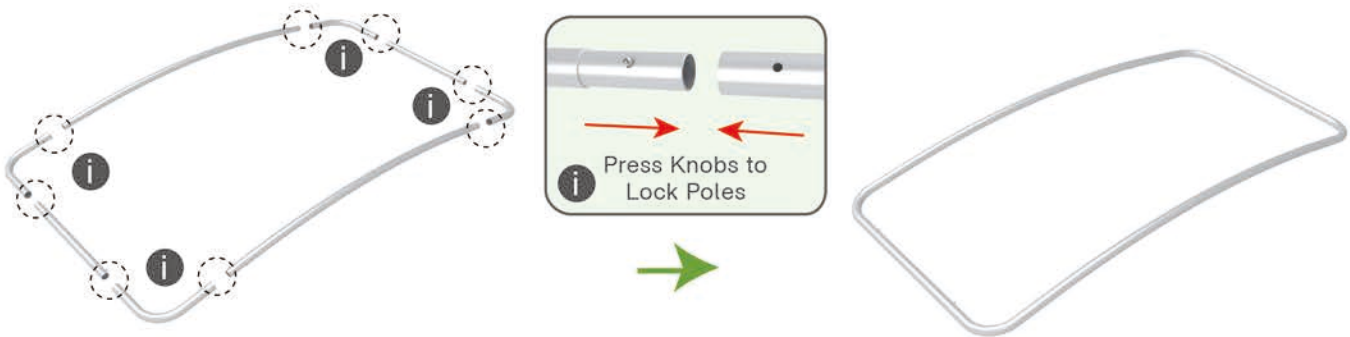

STEP 03 Connect support poles onto frame.

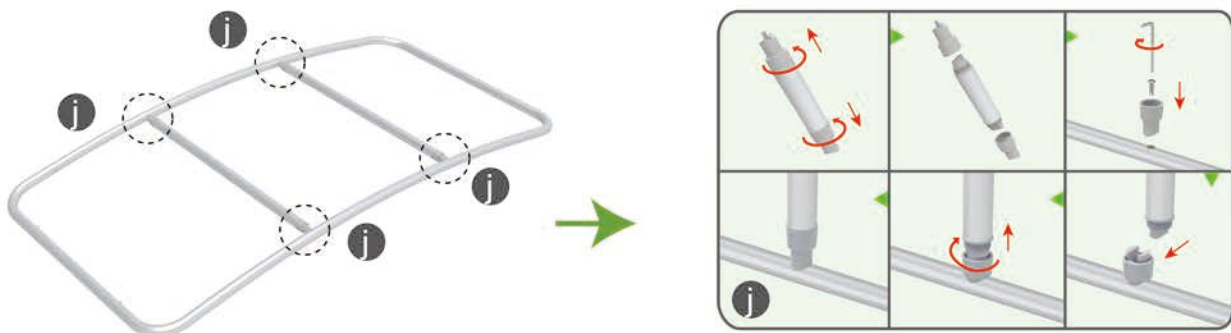

STEPS

STEP 04 Slide fabric banner on frame from left and zip up at right.



Booth Set Assembly

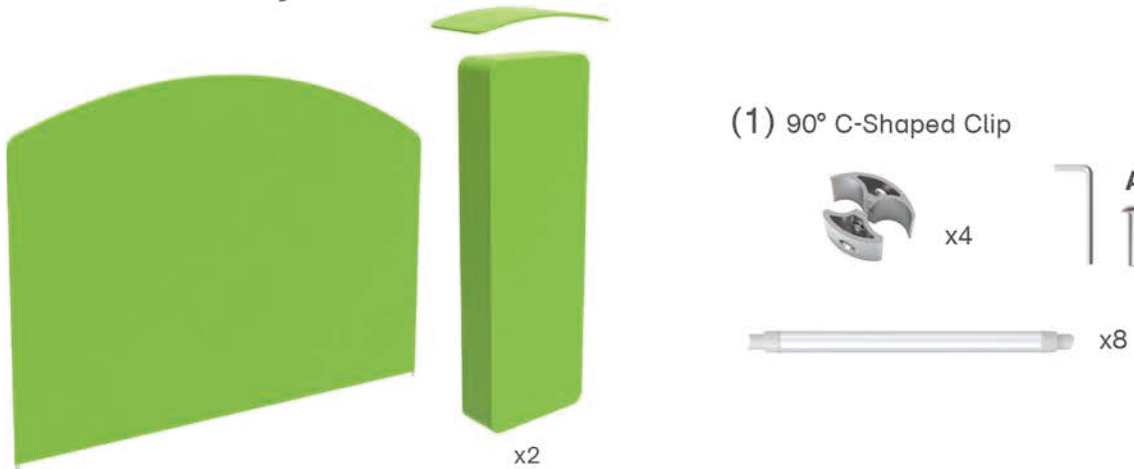

STEP 01 Connect support poles onto column frame and canopy.

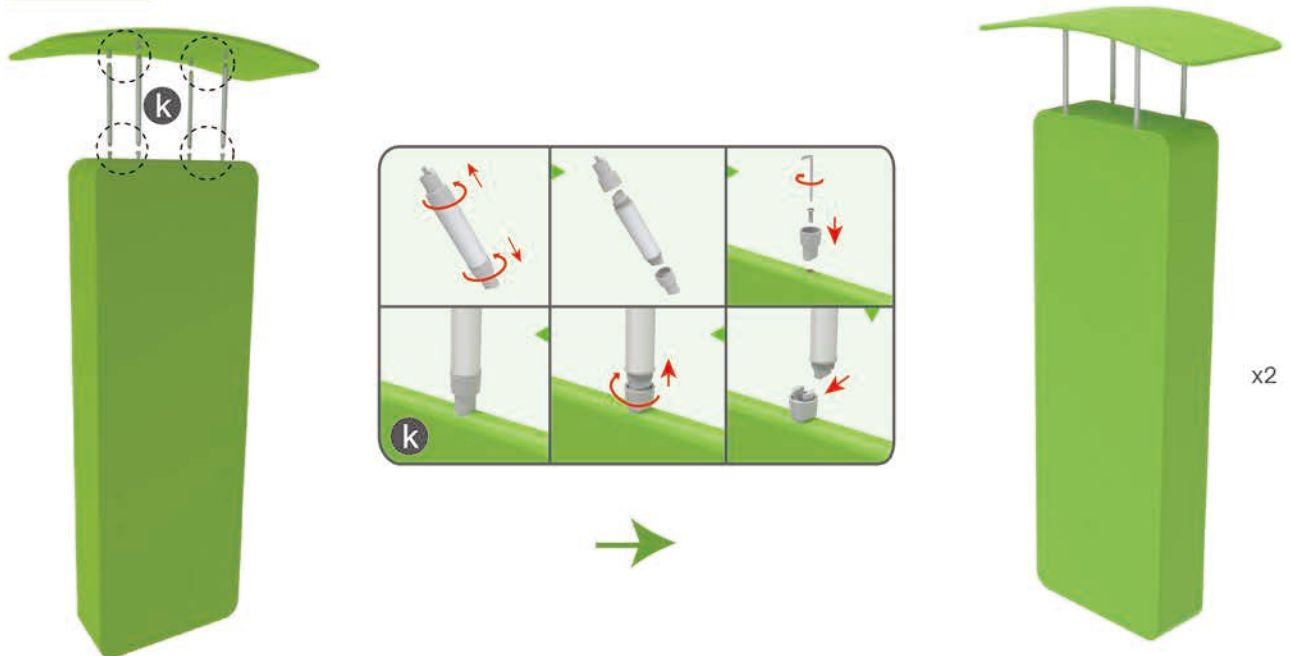

STEPS

STEP 02 Interconnect display stands with C-shaped clips.

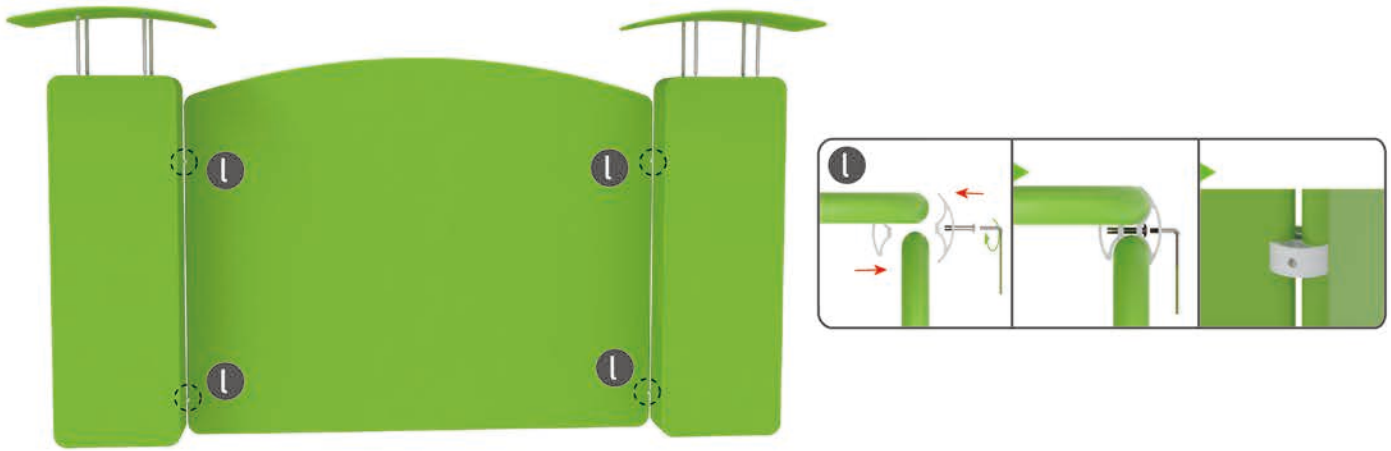

(1) Hardware

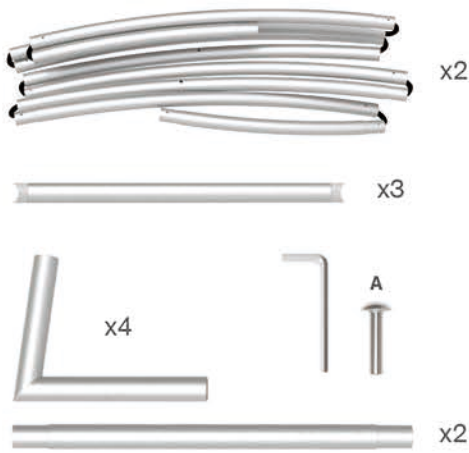

(2) Printed Graphic Fabric Banner (Optional)



STEP 01 Connect to make long poles according to labelings.

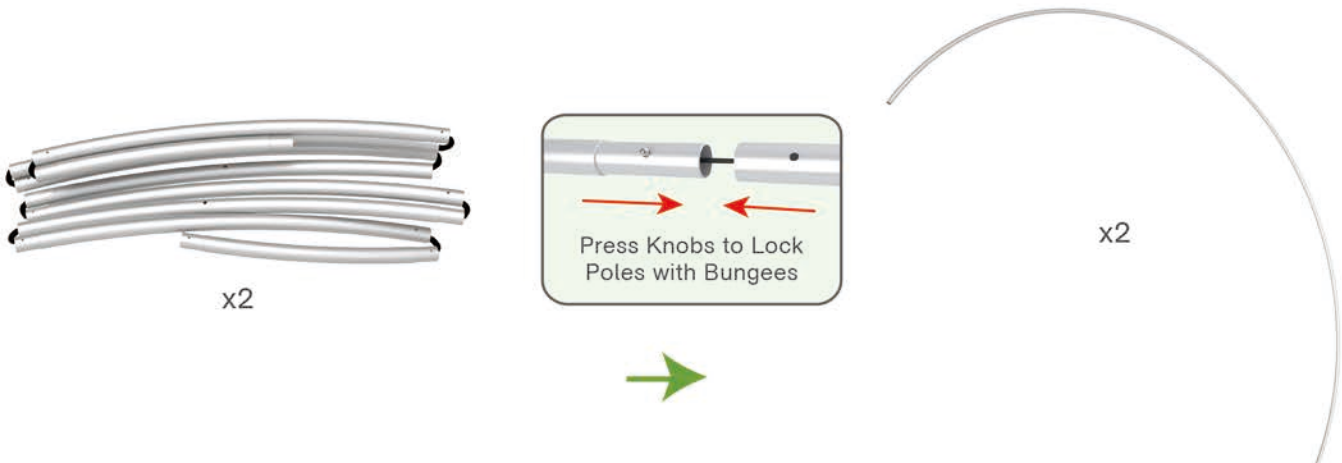

STEPS

STEP 02

Connect support poles onto frame.

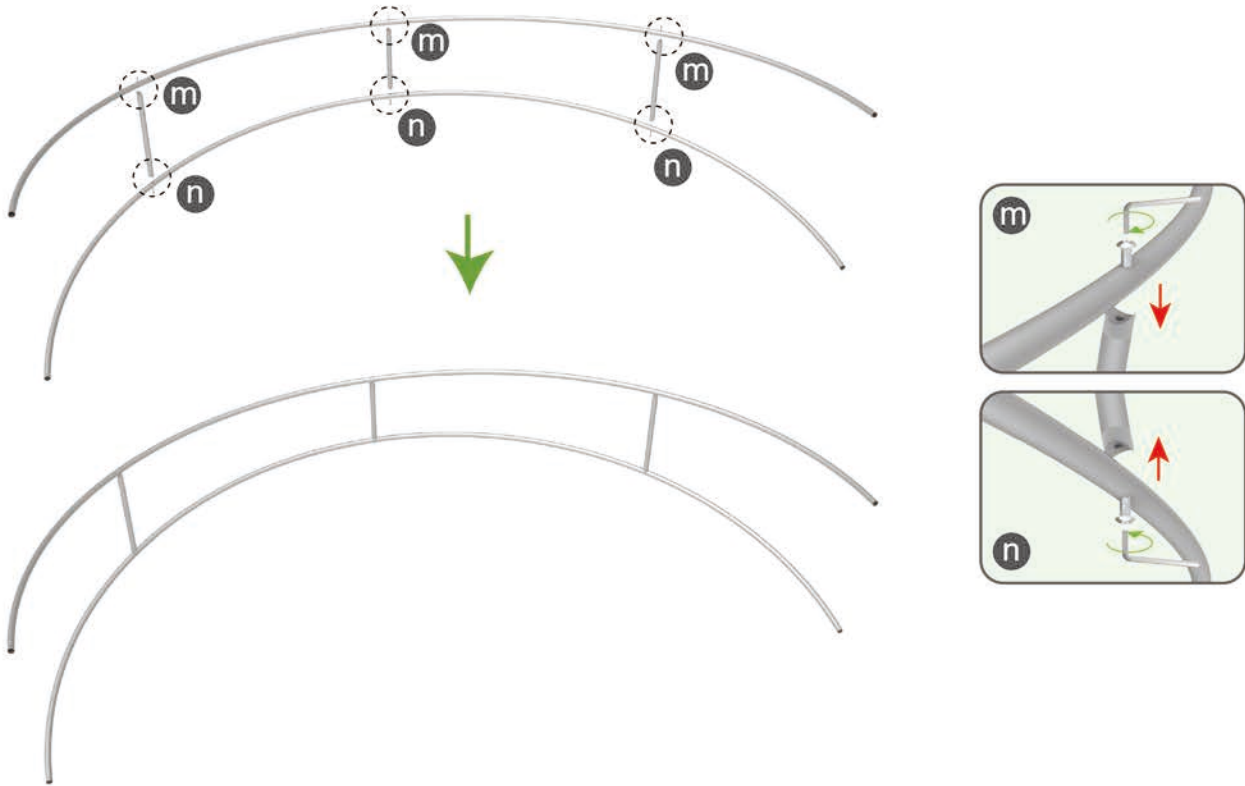

STEP 03

Connect long poles with corner poles according to labelings.

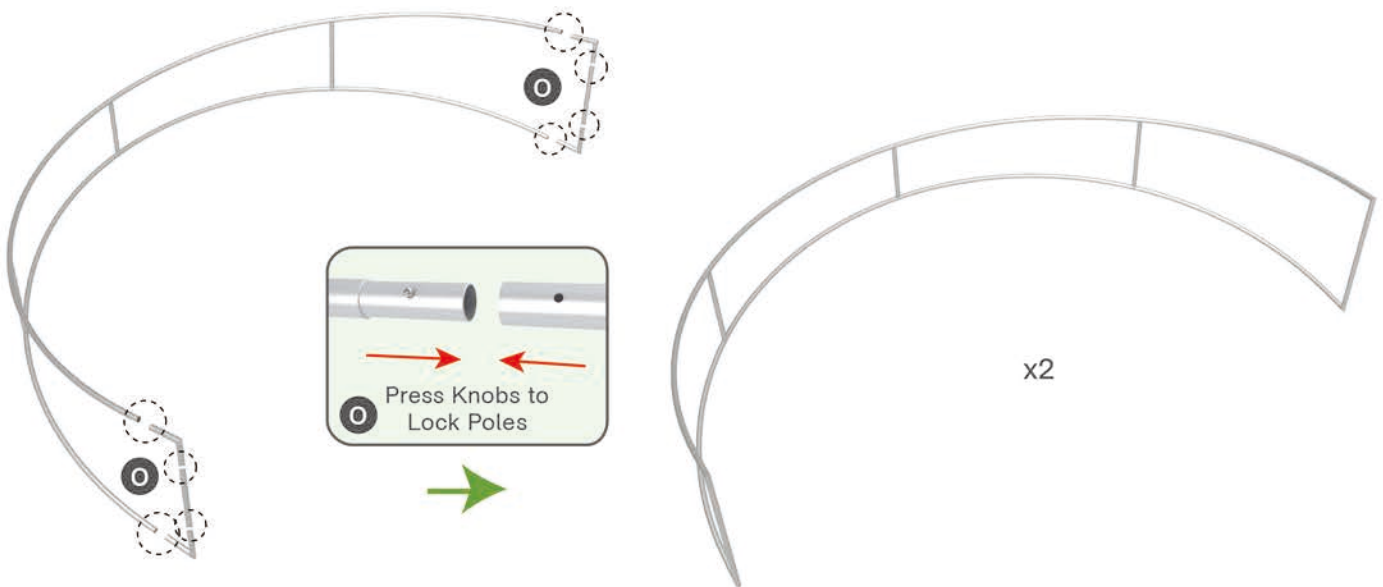

x2

★ One Tool (Hex Wrench) 

STEPS

STEP 04

Slide fabric banner on frame from bottom and zip up at top.

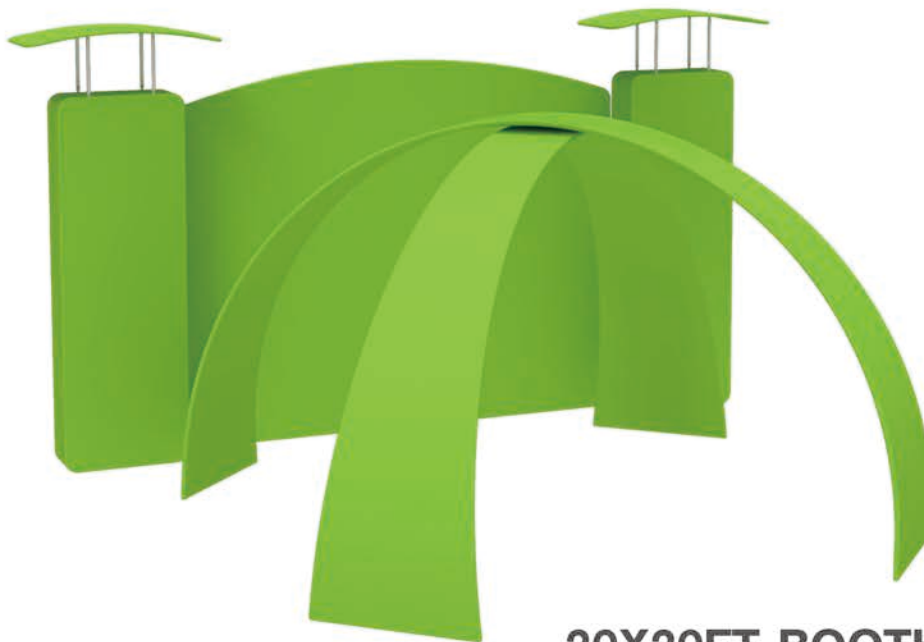

20X20FT-BOOTH-02