

FabLite BrightLine Panel F

FL-BL-PF

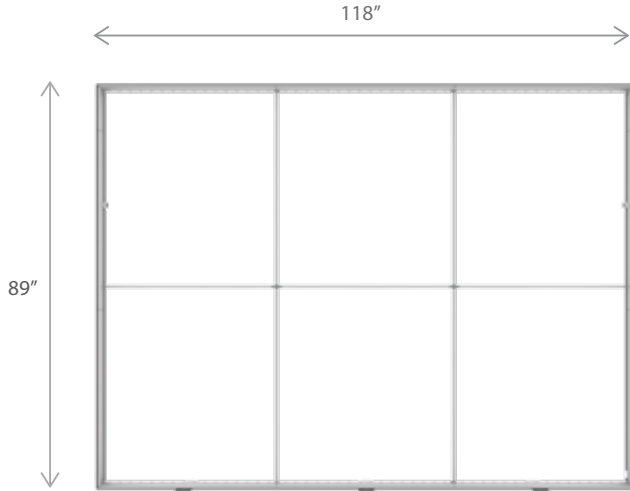

PRODUCT DESCRIPTION

FabLite BrightLine smart light box displays feature swift tool-free installation, durable light-weight frames, embedded LEDs, and exclusive One Planet recycled fabrics with impressive vivid graphics, all conveniently organized in a heavy-duty shipping case. Panel F seamlessly fills the popular 10ft exhibit, providing an illuminated backdrop for elevated branding.

Mix-and-match with other FabLite BrightLine panels to create unique branded environments. TV mounts, shelving units and counters complete an enhanced experience to really make brands stand out.

KEY FEATURES

- Easy tool free assembly
- Lightweight portable construction
- Magnetic power links
- LED lights encapsulated in frame
- Heavy duty shipping case, molded foam inserts
- Single- or double-sided
- Vibrant graphics on recycled fabric

DISPLAY CONSTRUCTION

Aluminum frame with aluminum support poles

DIMENSIONS

Assembled Unit	118"w x 89"h x 4"d
Packed Case	46.5"w x 15"h x 12"d, 70 lbs
Shipping Box	47"w x 16"h x 13"d, 72 lbs
Graphic Size	118"w x 89"h

GRAPHIC MATERIAL

Graphic Print : Dye sublimated on One Planet, 100% recycled, backlit fabric	Bottles recycled 76
Blocker : One Planet light block recycled fabric	Bottles recycled 30

LED LIGHT SPECIFICATIONS

Power Requirements	192 W
CCT (Color Temp)	6000 K
Voltage Input	110 / 220V
Voltage Output	24V 11A 264W
Transformers Included	1

GRAPHIC FINISHING

Silicone sewn edges

WARRANTY

Limited Warranty Periods

- Frame : Lifetime
- Lights : 90 days
- Graphics : 30 days

PARTS

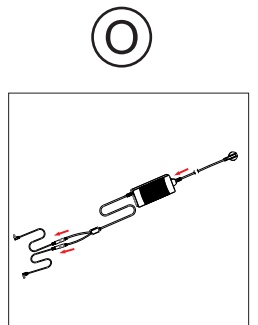
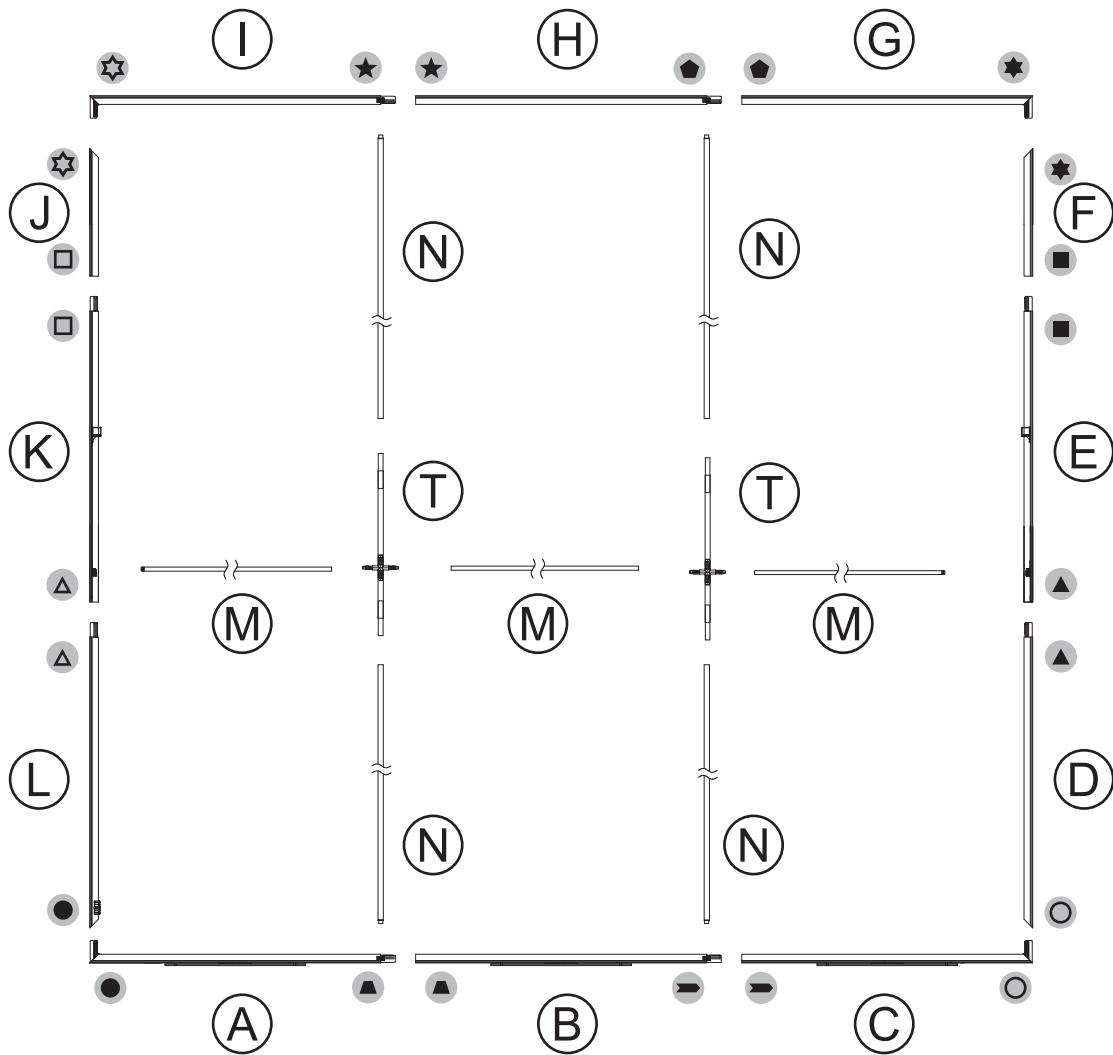

ASSEMBLY

Assemble parts on the floor and stand-up unit when completed.

1

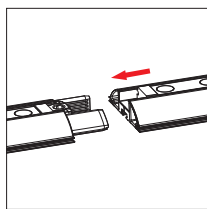

2

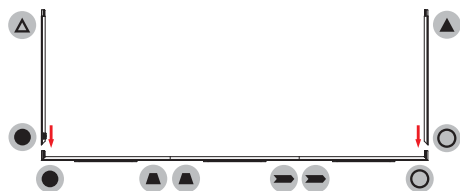
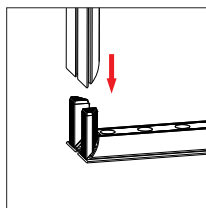

3

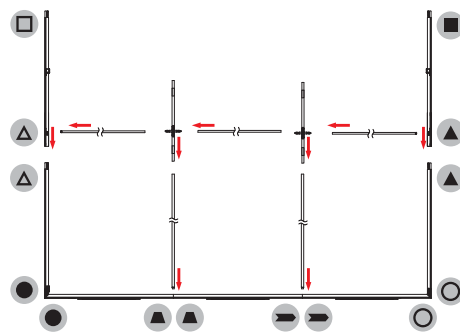
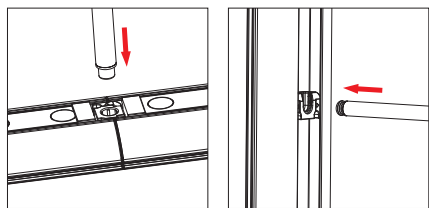

4

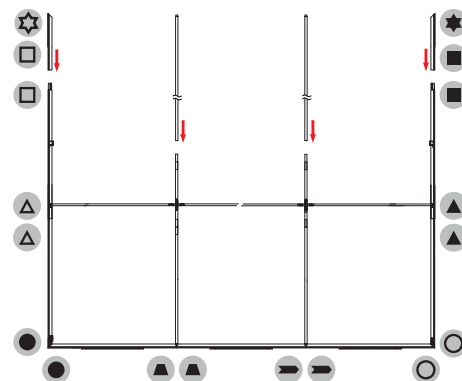
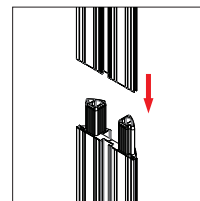

5

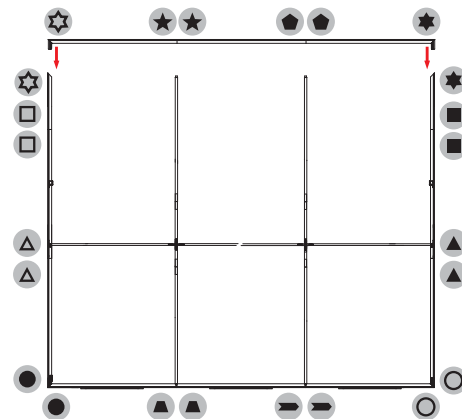
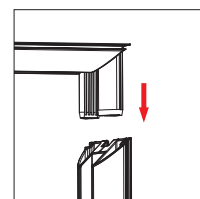

FabLite BrightLine Panel F

FL-BL-PF

- 6 Push the silicone bead into each corner of the frame with your thumb.

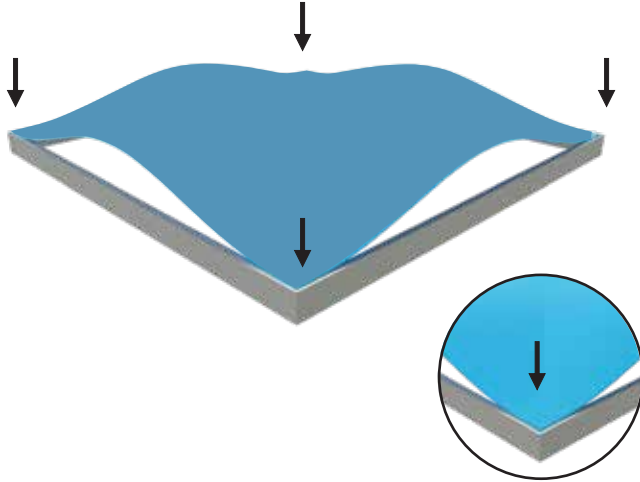

Push the silicone bead into the middle of the run and work your way around the perimeter of the frame until all beading is pushed in properly

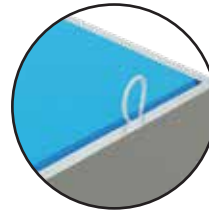
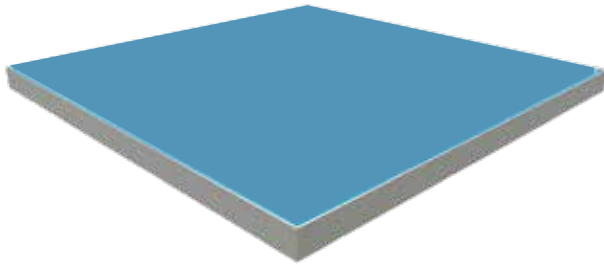
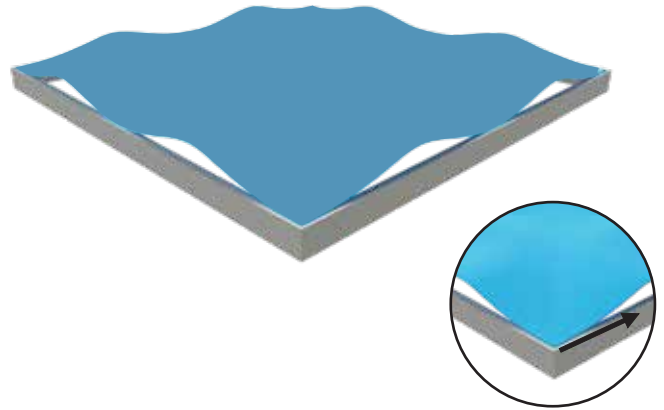

To Remove Graphic
Use the pull tab located on the graphic and gently pull the graphic from the frame, going around the perimeter

- 7

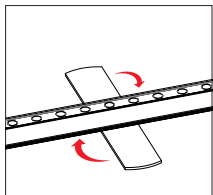
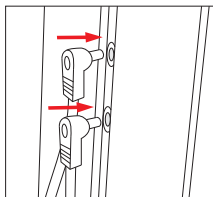

FabLite BrightLine Panel D

FL-BL-PD

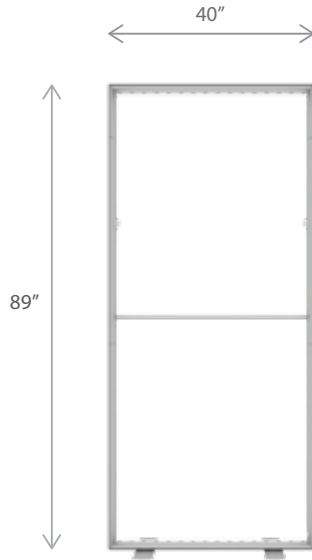

PRODUCT DESCRIPTION		KEY FEATURES	
<p>FabLite BrightLine smart light box displays feature swift tool-free installation, durable light-weight frames, embedded LEDs, and exclusive One Planet recycled fabrics with impressive vivid graphics, all conveniently organized in a heavy-duty shipping case. Panel D is sized for versatile applications, as a stand-alone banner or combined to create popular 10 foot and 20ft exhibits.</p> <p>Mix-and-match with other FabLite BrightLine panels to create unique branded environments. TV mounts, shelving units and counters complete an enhanced experience to really make brands stand out.</p>		<ul style="list-style-type: none"> • Easy tool free assembly • Lightweight portable construction • Magnetic power links • LED lights encapsulated in frame • Heavy duty shipping case, molded foam inserts • Single- or double-sided • Vibrant graphics on recycled fabric 	
DIMENSIONS		DISPLAY CONSTRUCTION	
Assembled Unit	40" w x 89" h x 4" d	Aluminum frame with aluminum support poles	
Packed Case	46.5" w x 15" h x 8.7" d, 43 lbs	GRAPHIC MATERIAL	
Shipping Box	47" w x 16" h x 10" d, 45 lbs	Graphic Print : Dye sublimated on One Planet, 100% recycled, backlit fabric	Bottles recycled 26
Graphic Size	40" w x 89" h	Blocker : One Planet light block recycled fabric	Bottles recycled 10
LED LIGHT SPECIFICATIONS		GRAPHIC FINISHING	
Power Requirements	64 W	Silicone sewn edges	
CCT (Color Temp)	6000 K	WARRANTY	
Voltage Input	110 / 220V	Limited Warranty Periods	
Voltage Output	24V 4A 96W	- Frame : Lifetime	
Transformers Included	1	- Lights : 90 days	
		- Graphics : 30 days	

PARTS

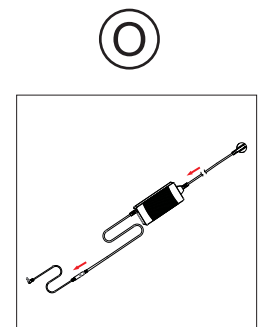
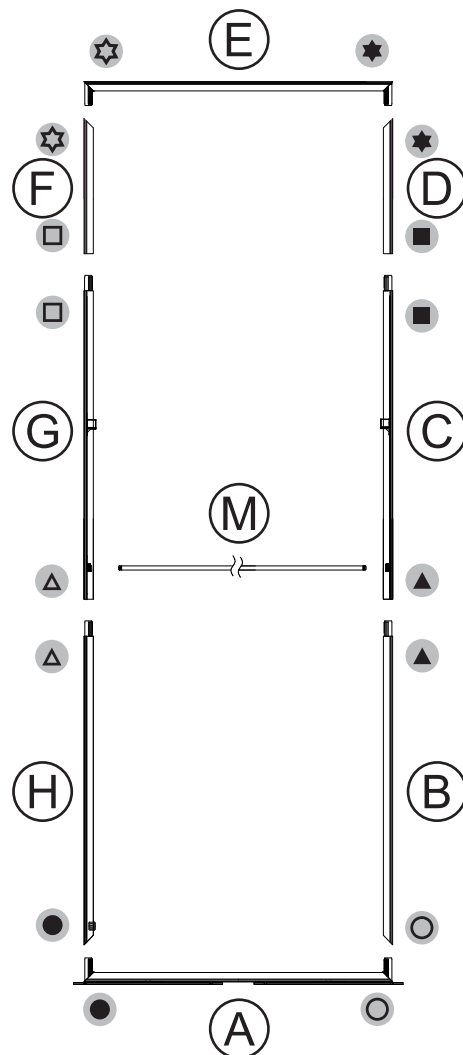

ASSEMBLY

Assemble parts on the floor and stand-up unit when completed.

1

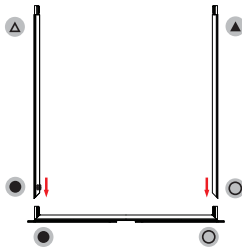
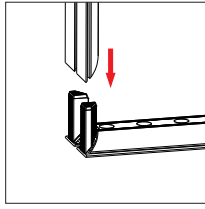

2

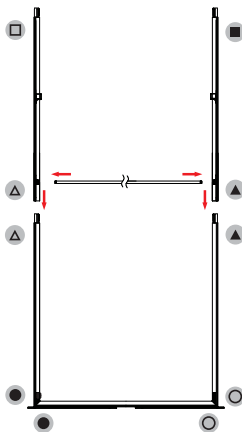
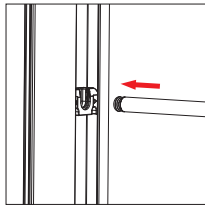

3

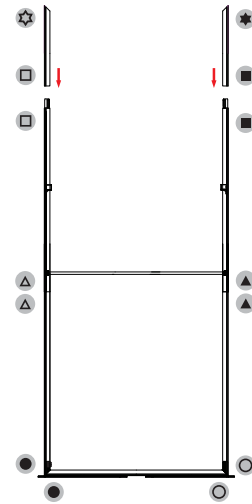
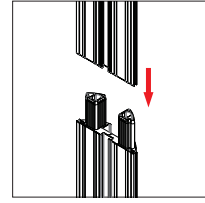

4

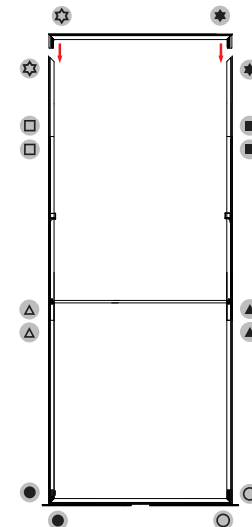
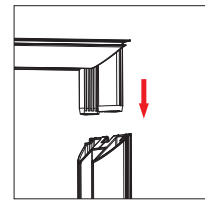

FabLite BrightLine Panel D

FL-BL-PD

- 5 Push the silicone bead into each corner of the frame with your thumb.

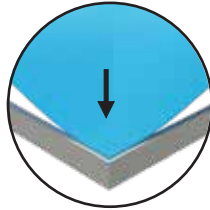
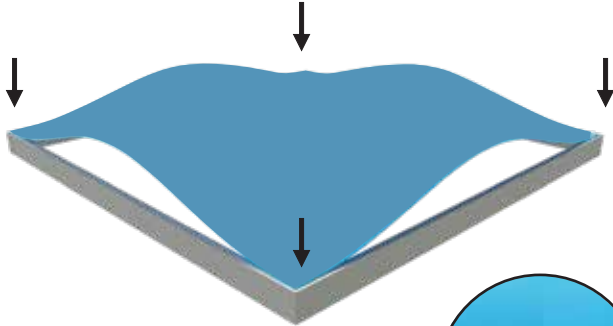

Push the silicone bead into the middle of the run and work your way around the perimeter of the frame until all beading is pushed in properly

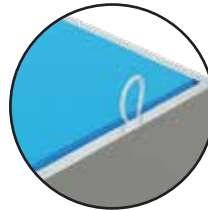
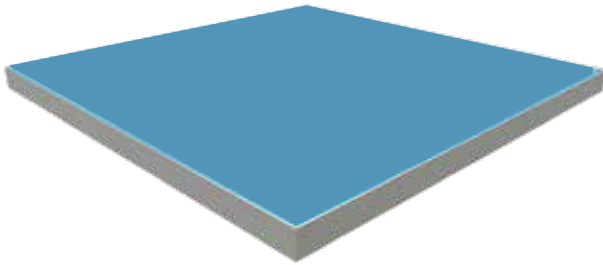
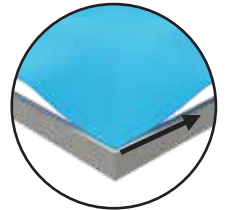
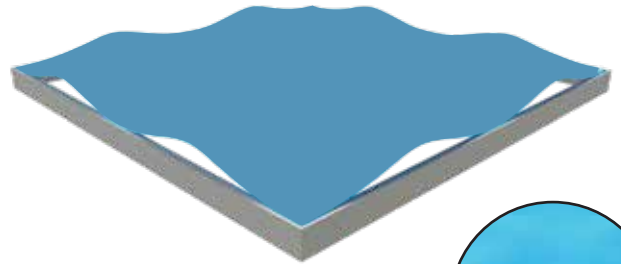

To Remove Graphic
Use the pull tab located on the graphic and gently pull the graphic from the frame, going around the perimeter

- 6

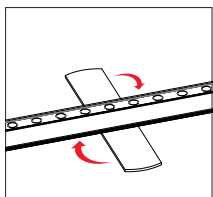
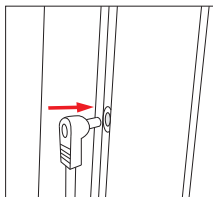

① *Align frames at 90°

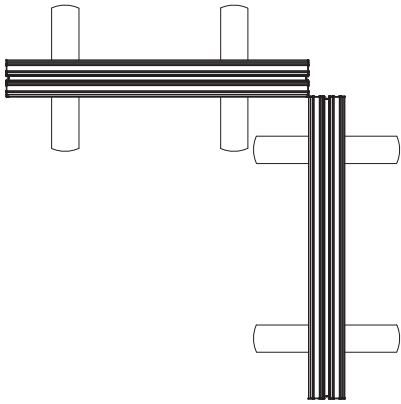

② *Insert connector into channel

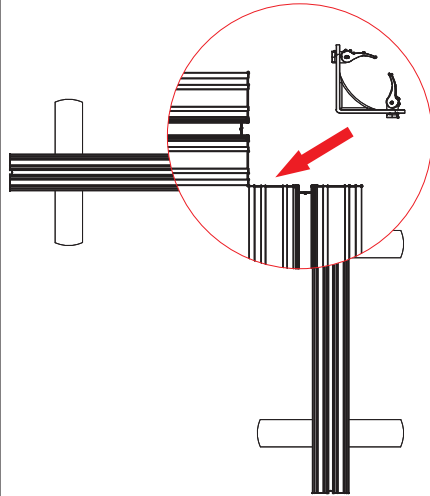

③ *Turn

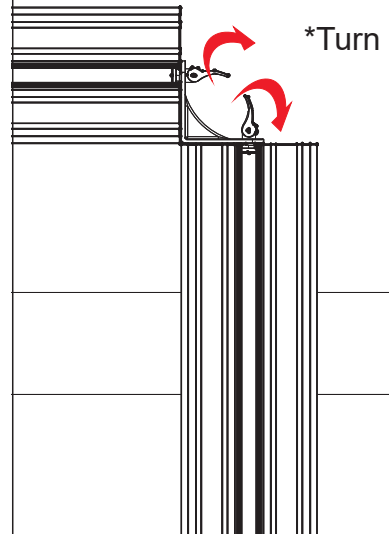

④ *Push down

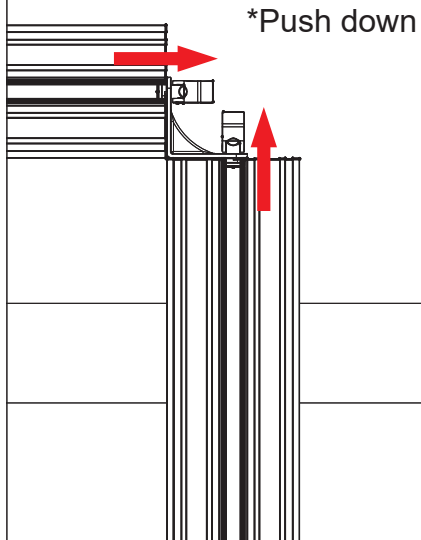

⑤ *Closed view

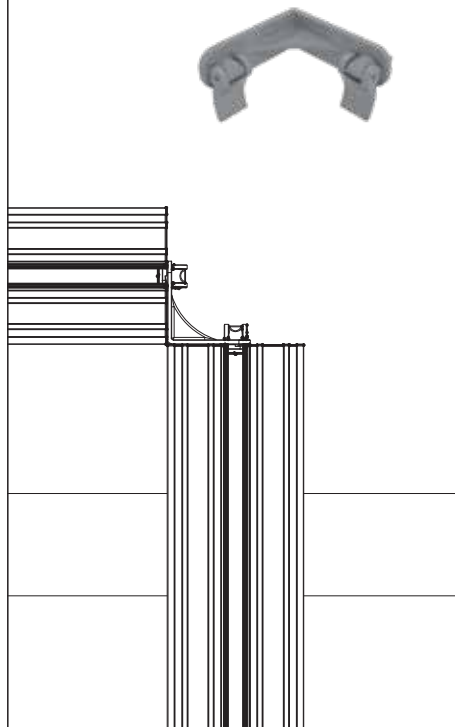

⑥

