

FabLite Backlit - FL-BL-20-01

FabLite Backlit light boxes feature durable 100mm aluminum extrusion frames, push-fit back-lit fabric graphics and LED top and bottom lighting. Single and double-sided graphic options are available. LED lights come adhered to the frame, making set-up as simple as assembling the frame, applying the push-fit graphics and plugging in the electrical cord!



features and benefits:

- 100mm (4") silver extrusion frame
- Integrated LED lighting strips top & bottom
- Single or double-sided push-fit fabric graphics
- Easy assembly
- Comes packaged with two OCH wheeled molded case for transport and storage
- Lifetime hardware warranty against manufacturer defects

dimensions:

Hardware

Graphic

Assembled unit:
236.5" w x 94.7" h x 19.7" d
6006mm(w) x 2405mm(h) x 500mm(d)

Refer to related graphic template for more information.

Approximate weight:
190 lbs / 86 kgs

Visit:
<https://www.theexhibitorshandbook.com/download-graphic-templates>

Shipping

additional information:

Packing case(s):
2 OCH

Graphic material:
Backlit Intensity push-fit fabric graphics

Shipping dimensions:
50" l x 29" h x 12" d
1270mm(l) x 737mm(h) x 305mm(d)

When included in a larger kit, a different packaging solution will be listed to accommodate all contents of the kit. Individual packaging no longer provided.

Approximate total shipping weight (includes cases & graphics):
244 lbs / 111 kgs



This product may include the following materials for recycle:
aluminum, select wood, fabric, cardboard, paper, steel, and plastics.

1 person assembly recommended /
2 person graphic application recommended:



*Not to scale

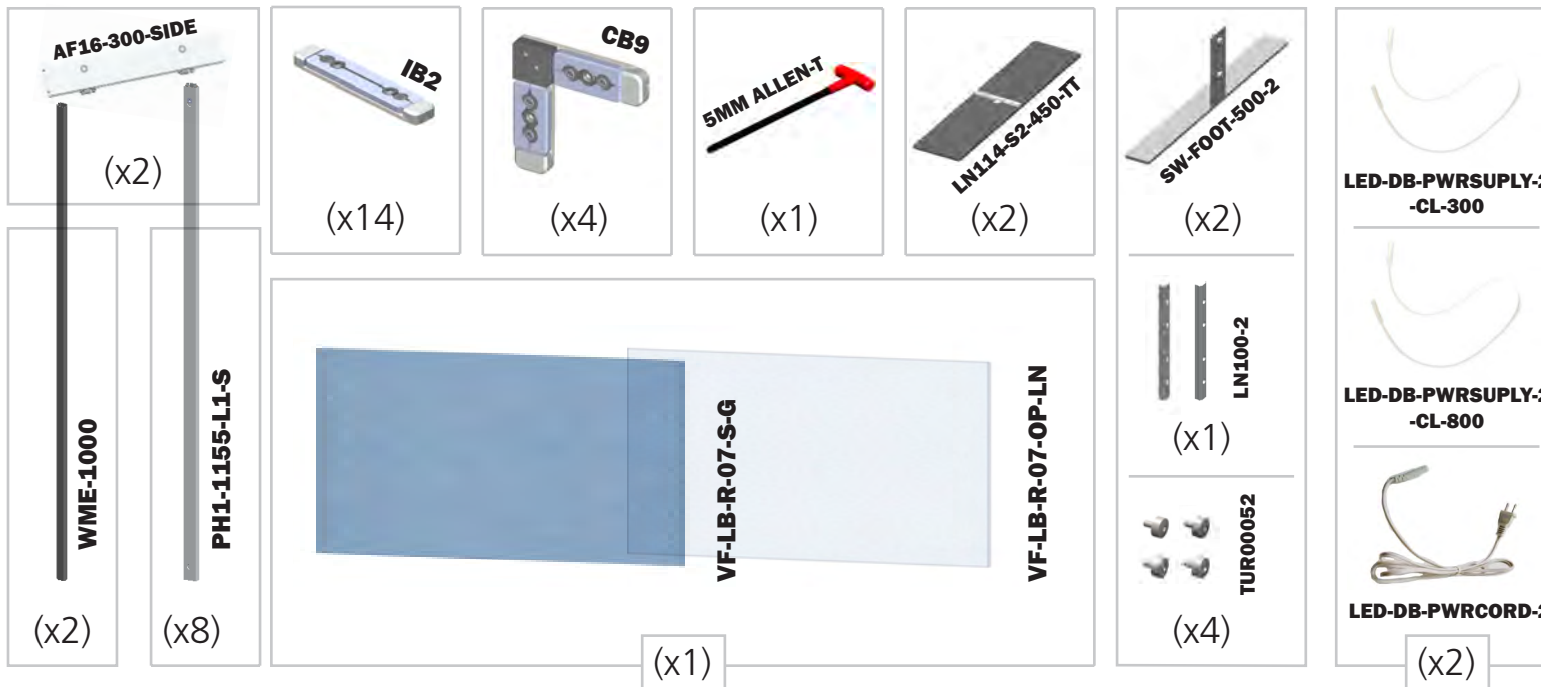
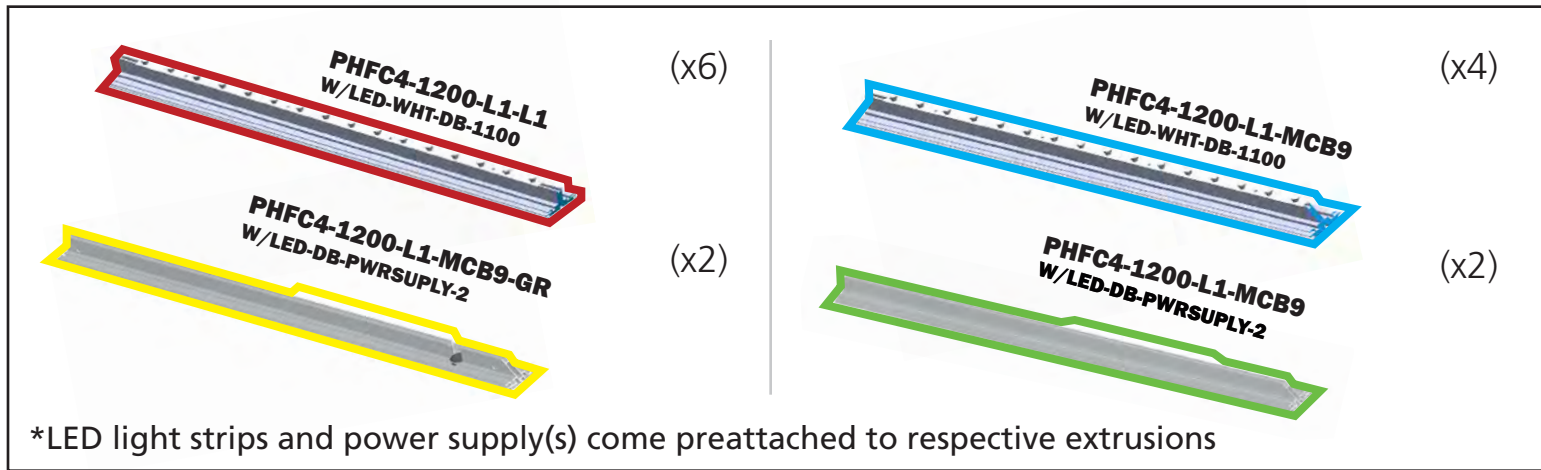

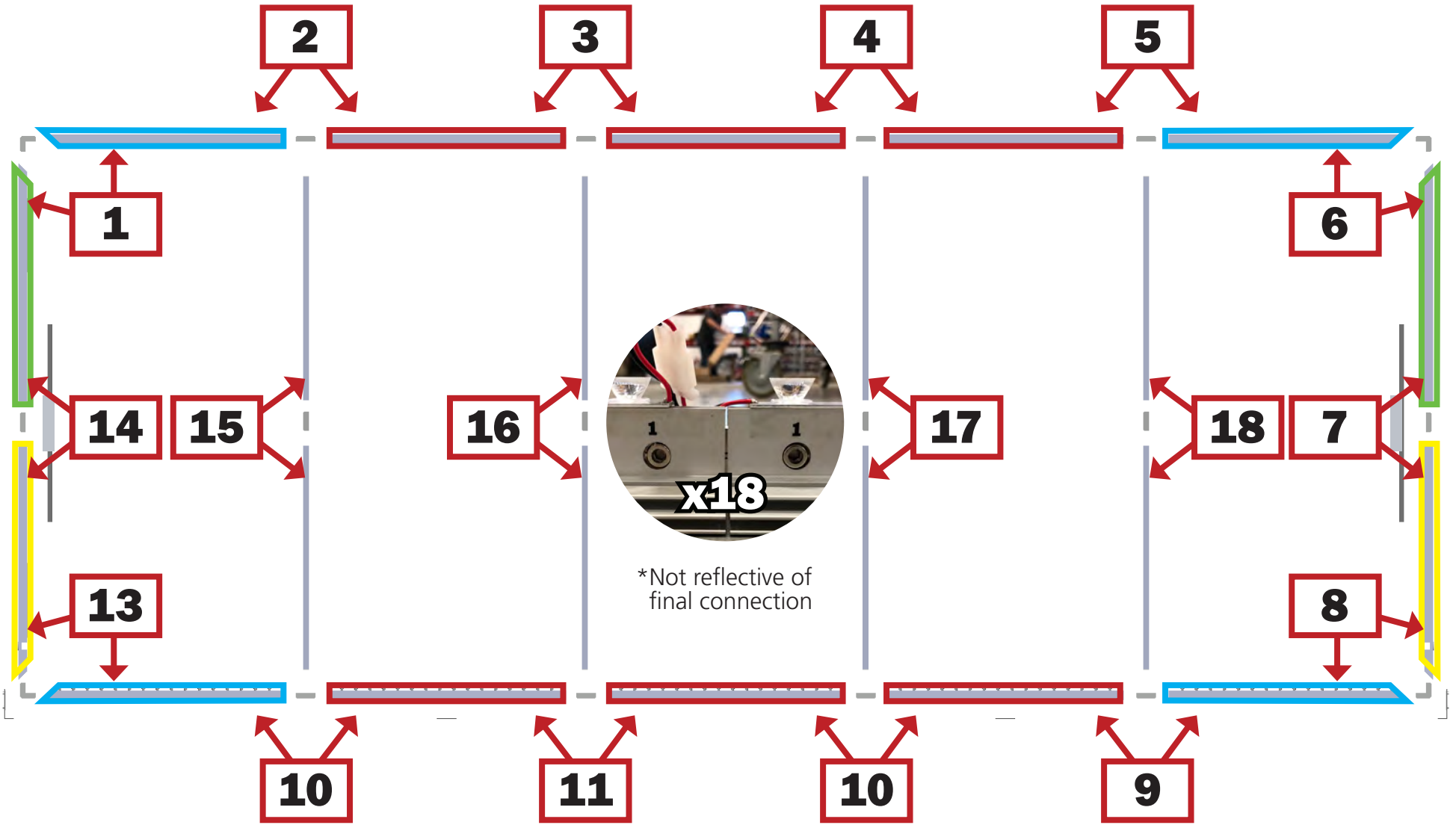

Back View



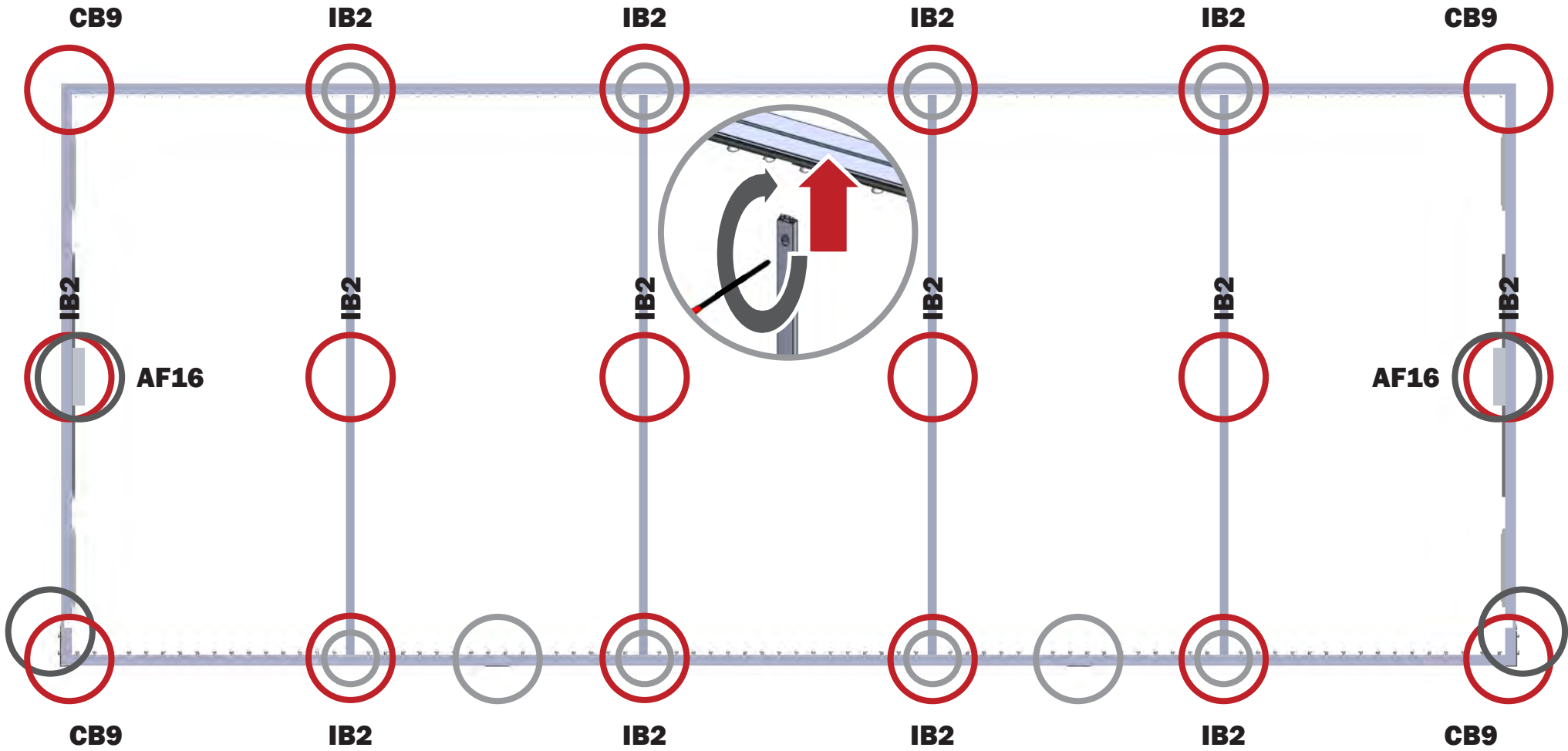

*CB9 & IB2 connection are consistent

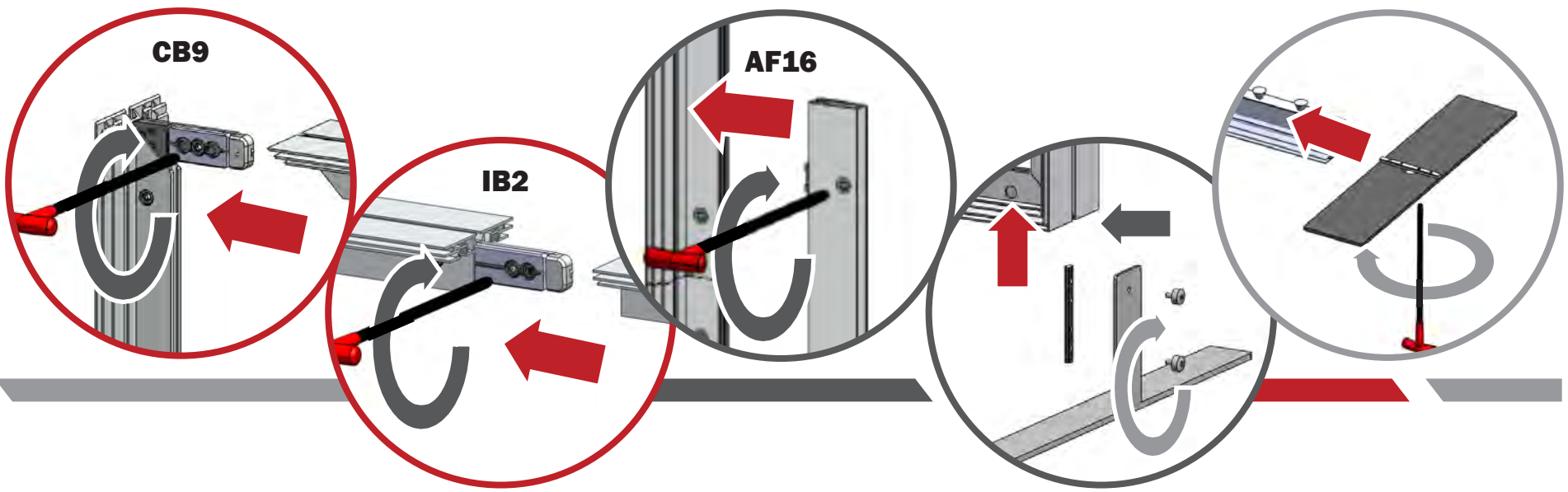

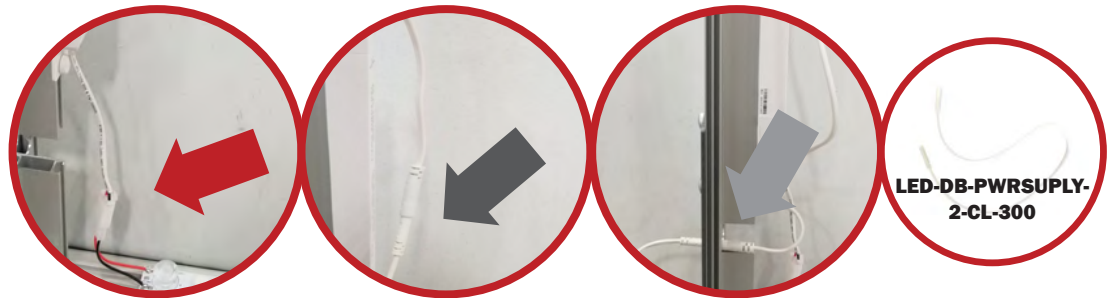
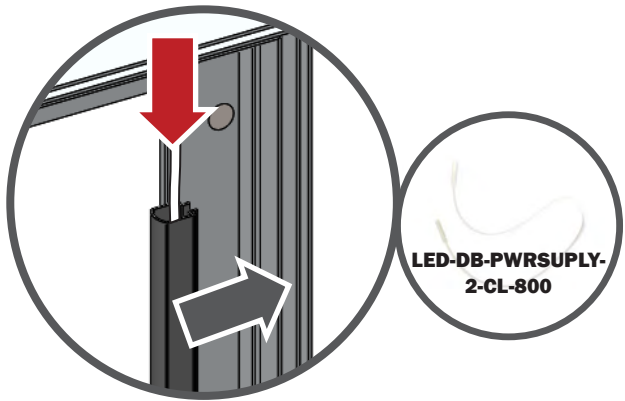

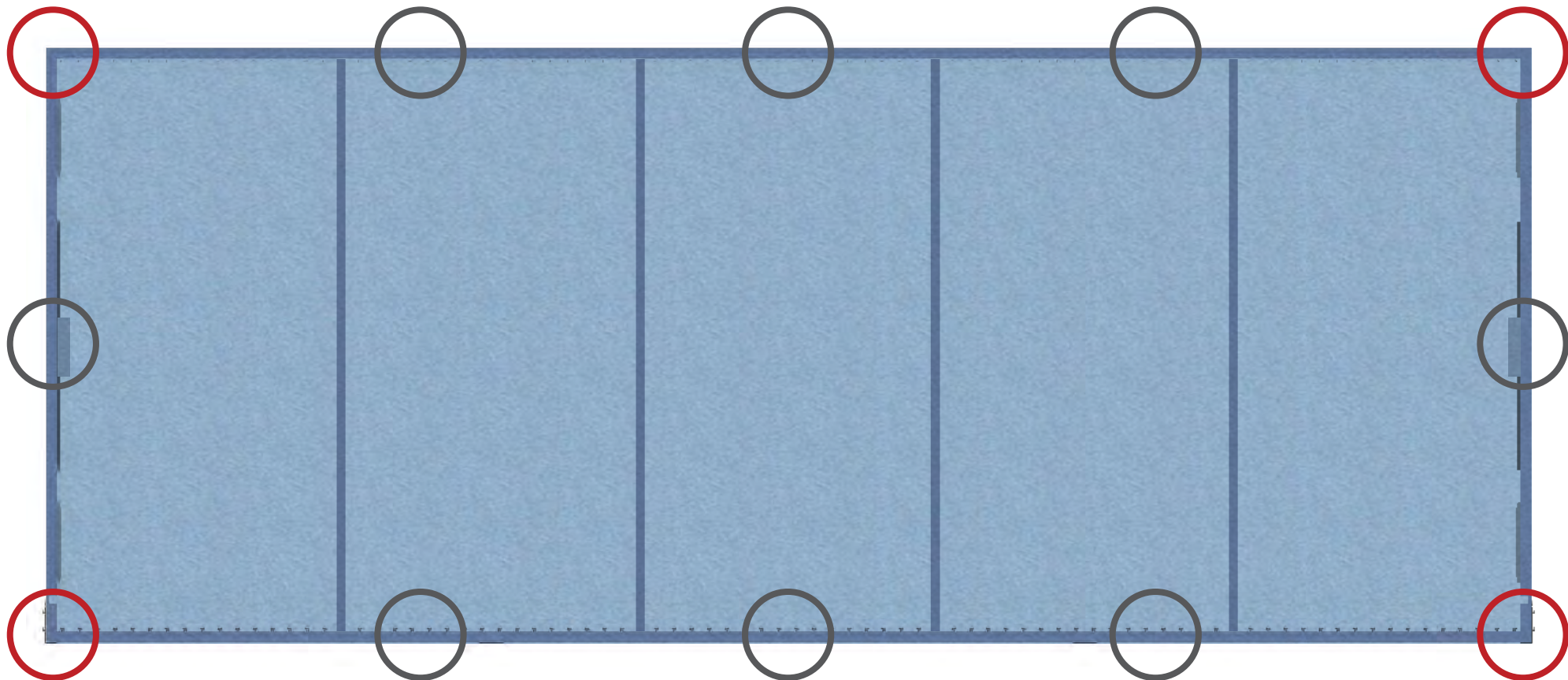

Fit graphic into corners, then "tap" into rest of frame channel.

"Sliding down" graphic is not recommended for best installation.

Repeat for backer.

